

# Mello: Design Documentation

## Index

1. Typography
2. Colours
3. Interface Elements of Specific Interest
4. Animation and Transitions
5. Features Worth Mentioning
6. Interactive Texture of the Experience

## Typography

There are 3 typefaces used across the experience of this website. The three of them are:

1. Tw Cen MT Std. (For Main Headings)
2. Montserrat (For all levels of Subheadings)
3. Oxygen (For the content)

These typefaces can be found at the following websites

1. Tw Cen MT Std: [Download Tw Cen MT Std - Regular](#)
2. Montserrat: [Montserrat](#)
3. Oxygen: [Oxygen](#)

Tw Cen MT is used for all the high level headings (like website page, or login headings, etc.).

Montserrat is used for Section Headings and used for all second, third and fourth level of hierarchy headings.

Oxygen is used for all the content in the website and occasionally for card headings and highlighting sub-body text (active links in the webpage).

## Colours

The colours used in Mello are different shades of the colour blue. The colour is used in 4 hues. Usage is clear from design files.

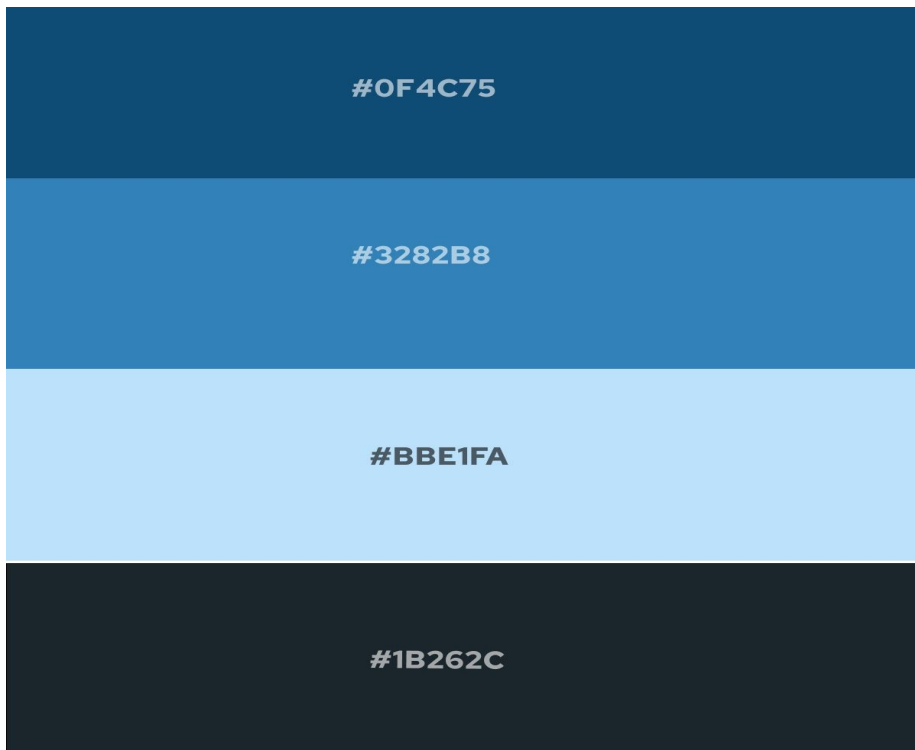

More colour themes to the website will be added soon.

# Interface Elements of Specific Interest

## 1. Side Navigation

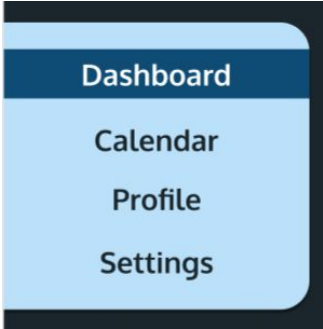

The main side navigation is accessible from all the pages of the website. It is permanently in view across all pages (non collapsible). The current page of the user is highlighted through a dark blue rectangle.

## 2. Chat Channel

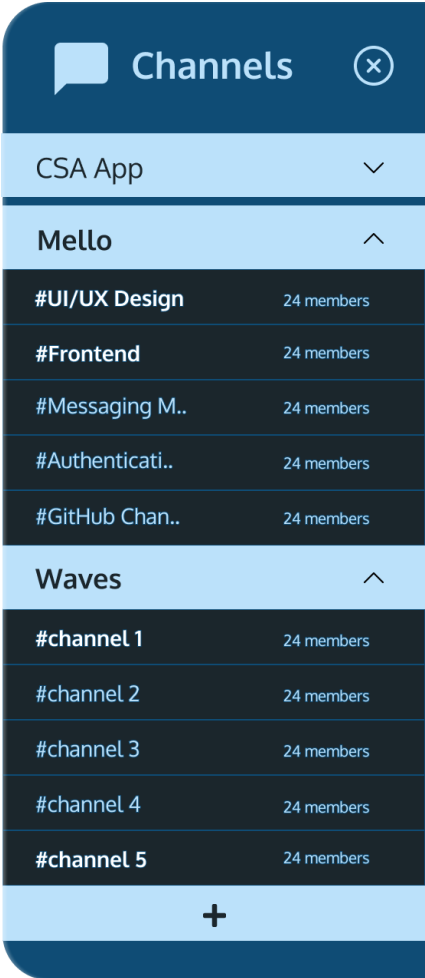
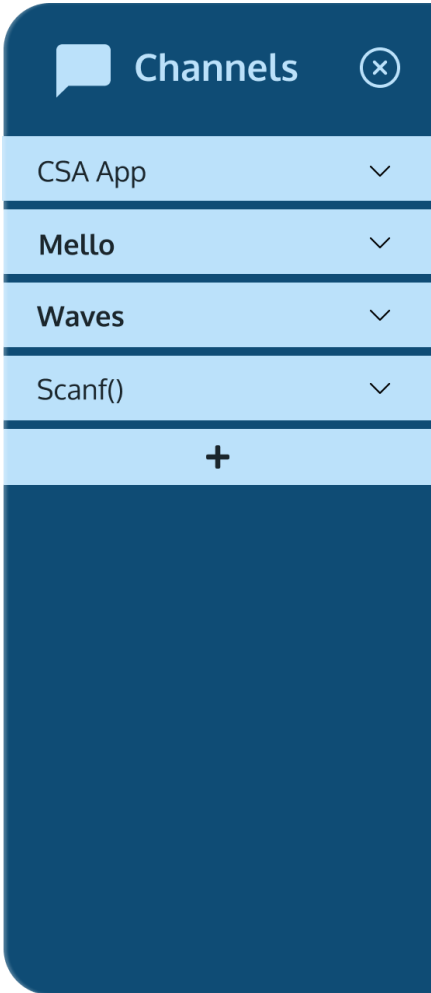

The chat channel is a collapsible channel which pops out when the chat icon is clicked. When this is active, there is a dark overlay on the background. The individual channels of projects are displayed in a nested drop down menu and they are vertically scrollable. Clicking on a particular channel redirects to the channel page. The channels which have unread messages are displayed in bold. The + icon at the bottom is for creating a new channel and a popup opens when this is clicked.

### 3. Notification Drop Down

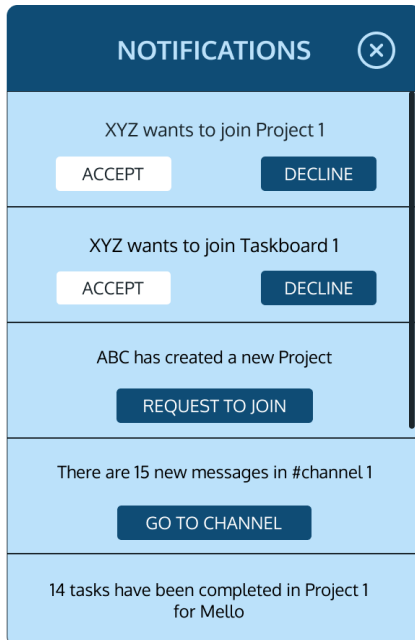

This drop down menu is visible upon clicking the notification bell icon in the top navigation bar. The admin has the option to accept or decline the request of any member to join any project. When this is active, the background has a dark overlay. Notifications are vertically scrollable.

### 4. Theme Settings

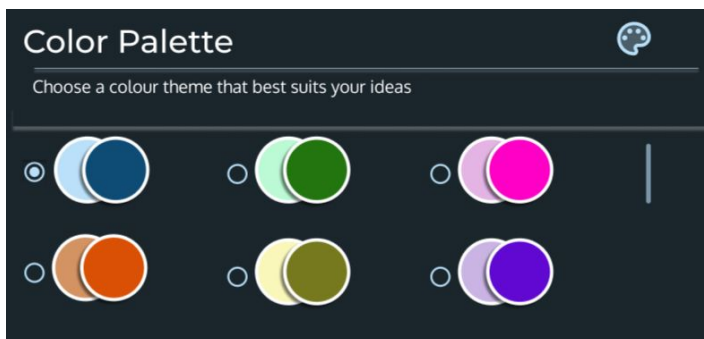

Different colour palletes are available for setting as the theme of the entire website. By default the theme is blue. Once another theme is selected a popup appears confirming the same.

## 5. Mute channel and collapse icon



These icons are present in the bottom left corner of the messaging module. User can quickly mute/unmute the channel and exit from messaging module.

## Interactive Texture of the Experience

The entire experience is meant to feel quite informal and not very work-related. Apart from the curved corners and the non-conventional shapes of the cards in side-nav and the top-nav bar which already convey this feeling, even the interaction with the interactive elements try to convey this.

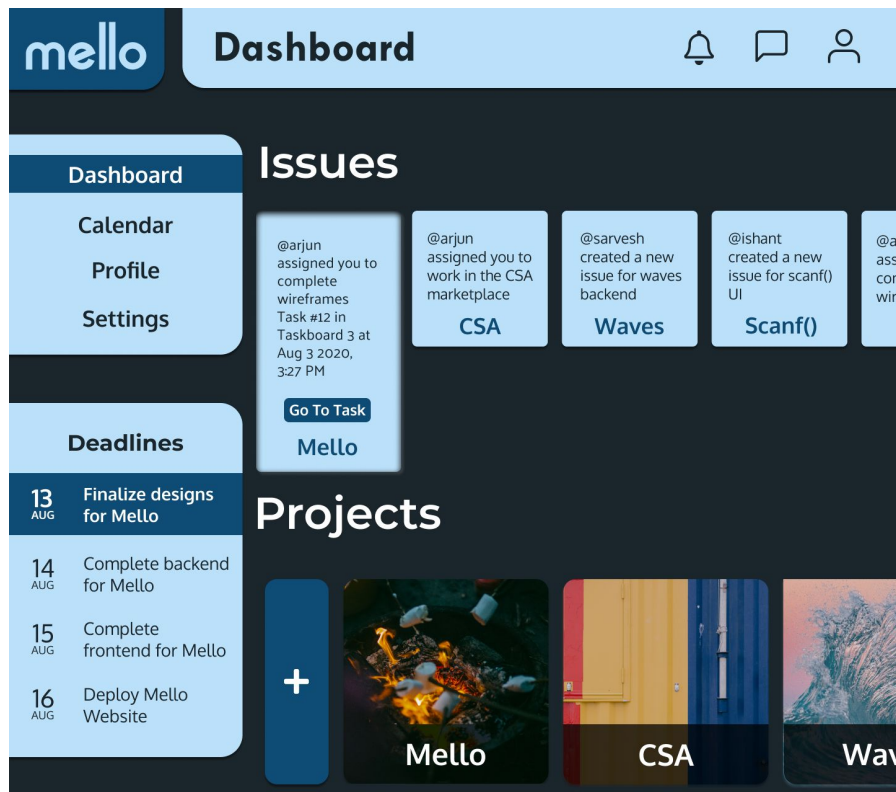

This is a snippet of a user interacting with a card element in a particular card-list. Upon hovering over the card, the card rolls down expanding itself and thus revealing more information about the contents of the card.

## Animations

*The default animations on the website will be due to the use of Material UI components and cards. Special Animations to add are listed here:*

### Get Started:

*While the web page is loading (we could keep a few sec delay here), the logo would cover the entire screen. The fire on the marshmallow in the Mello logo would be live and burning (gif). As soon as the page is loaded the logo would shrink to the left side of the screen and Login options would show on the right side.*

*When just logged in, just before showing the Dashboard, the Mello logo could shrink radially to the top left corner of the screen with the transition time of about 0.5s. Other elements of Dashboard could appear immediately after.*

## Dashboard

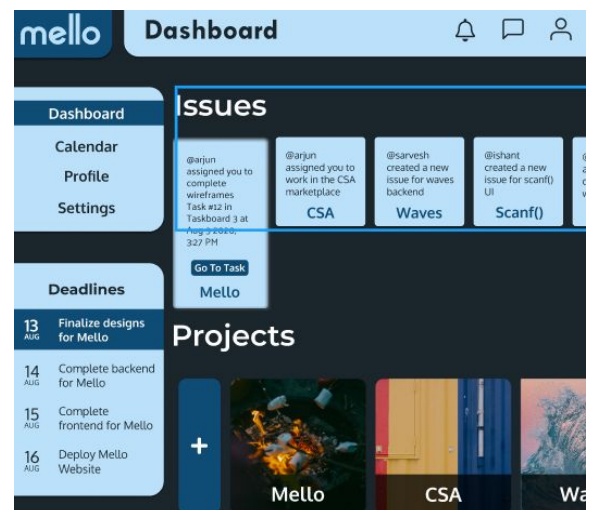
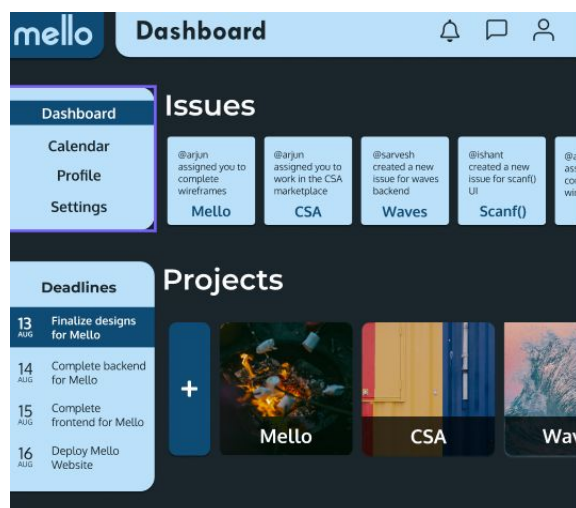

→ When you hover over the Issues cards, It increases in length and shows more information about the issue with an “Assign me” button.

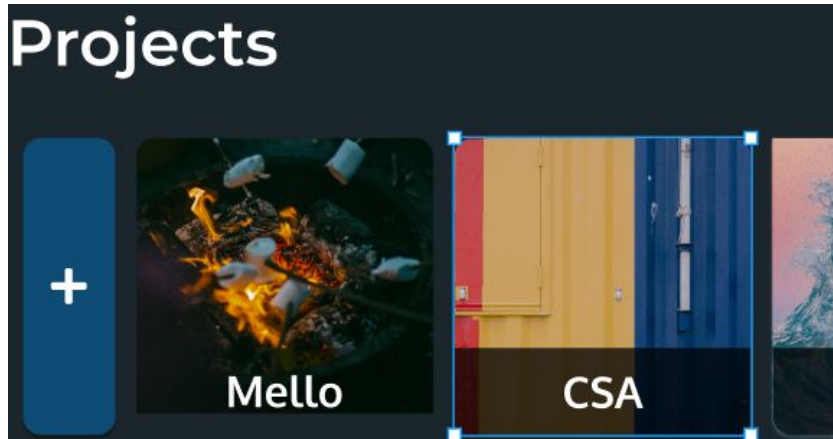

→ When you hover over the Projects cards, the title of the project card travels to the top of the card with the translucent black screen covering the entire card. Important info or minor details about the project is shown on the black screen

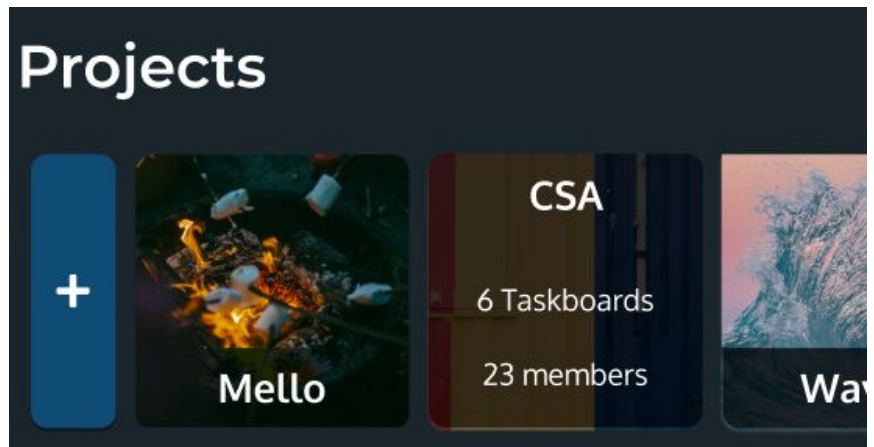



→ When one clicks on the Project Card, the height of all cards are reduced to contain the title and there would be a dropdown showing the Projects TaskBoards.

## Taskboard

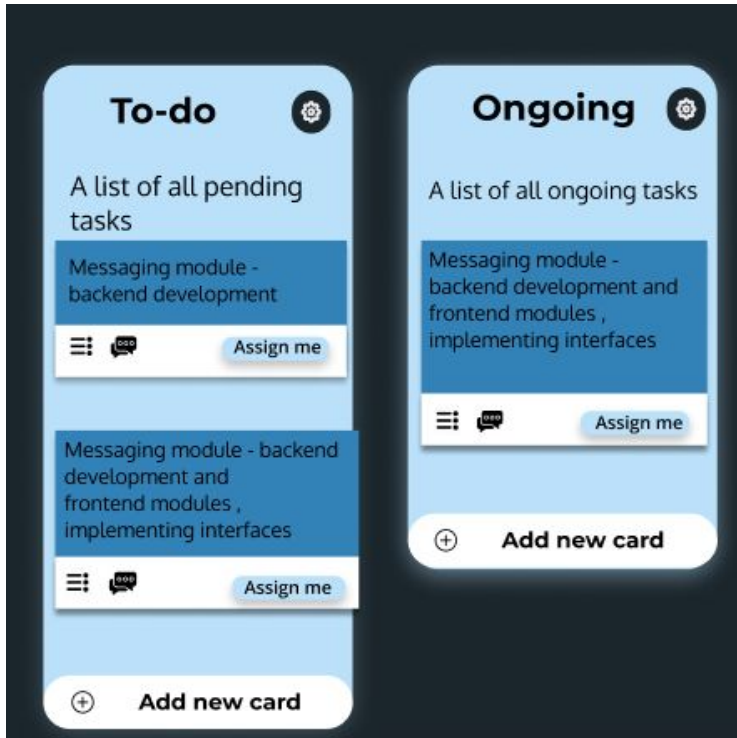

→ When you hover over a task on the TaskBoard, the task could slightly increase in length in the X direction (right) just to show some sort of satisfaction while browsing through tasks.

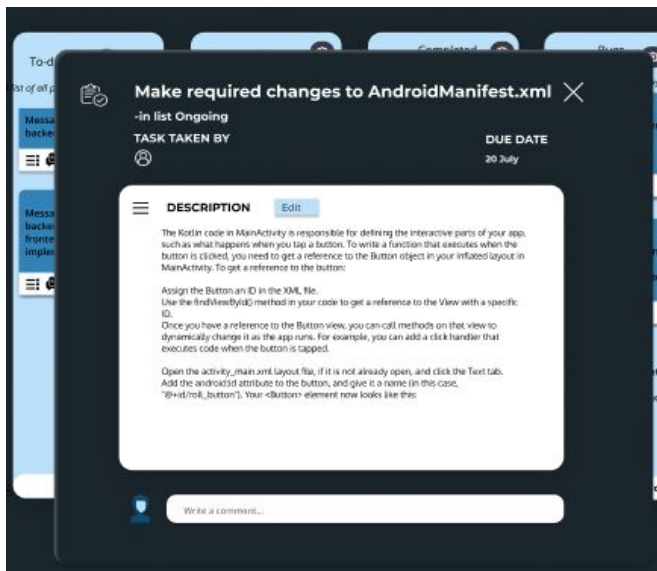

→ When you click on a Task, the description popup “flips open”. I am not sure its possible, but it could create the effect of “turning over an information leaflet”.

## Chat Channel

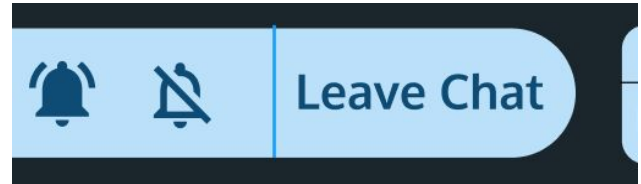
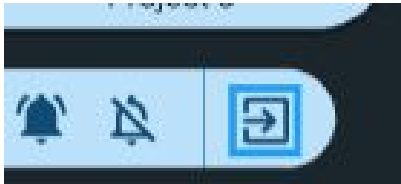

→ When you hover over the leave Chat button, the text “Leave Chat” could slide in the button before you click it.

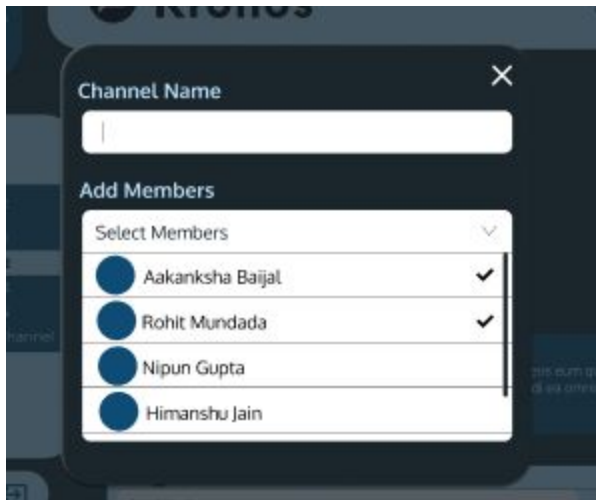

→ All the popup windows could grow in size with a transition of about 0.2s to show a satisfactory popup.



→ All the right side drawers could slide out from the right side with an appropriate transition time of about 0.2s. ?

## Settings and Profile Page

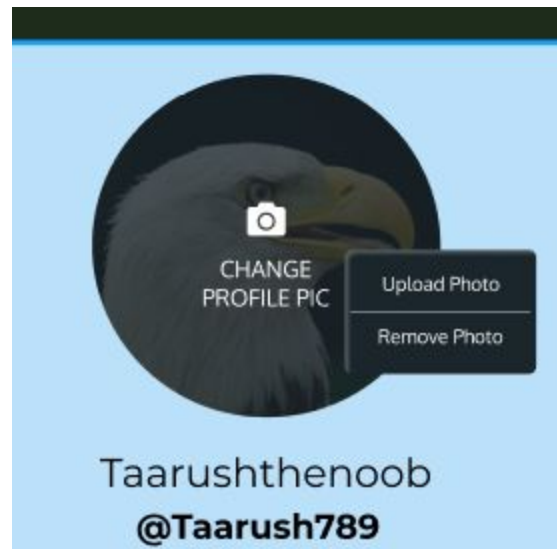
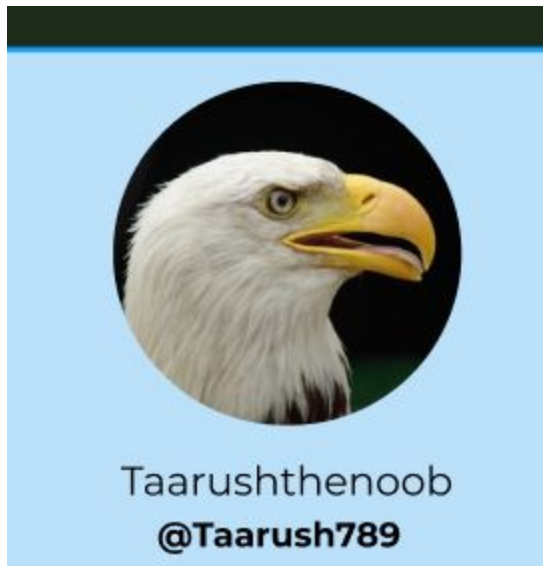

→ When you hover over the profile picture, a see-through black screen would appear over the Profile picture with the option of changing your profile Pic.



→ When you hover/select a color theme, the color theme would change on your screen starting from the top left corner( the logo) radially covering the entire page in a time of about 0.4-0.5 s . ?

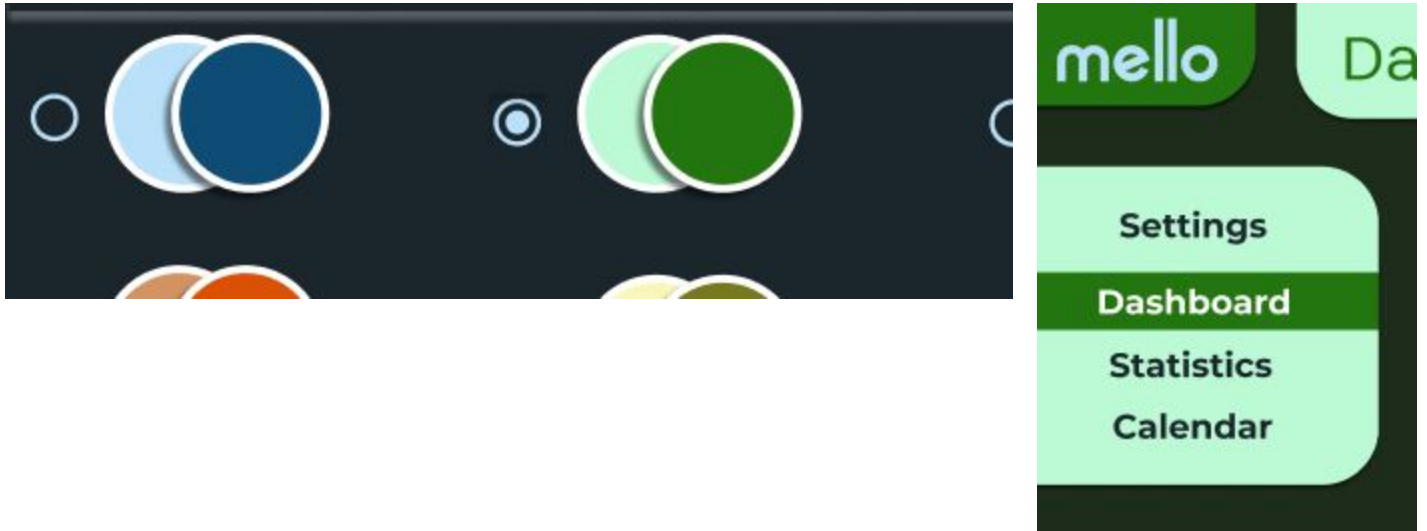

## Calendar

- When you hover over the exit button, the text "Exit" could slide in from left into the button before you click on it.