

54*85mm



User Manual

Introduction

Thank you for choosing WIMA product. Please read this manual carefully before use.

1. The key must be registered before use, ALL key have been registered in manufacture.
2. The key usage is same as classic key, but when you insert a right key, you will hear a "beep", that means unlocked.
3. The cylinder can be linked to Mi App. (this function depend on Mi sever in your location)
4. Besides the mechanical structure, the product is also equipped with an electronic device inside. any oil / liquids is strictly prohibited put in to cylinder.
5. Please keep the key clean to make sure good contact with cylinder.
6. This product contains alkaline batteries, please stay away from the fire / hot source.
7. Make sure battery model is LR1 AM5 Size N1.5V
8. Please keep at least 1 legal key to unlock It is absolutely necessary to open your door.

Note 1. Make sure voltage 1.5V
2. Correct + / - direction

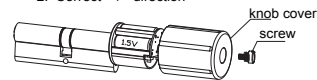

Fig. 1

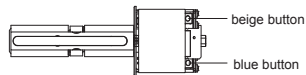

Fig. 2

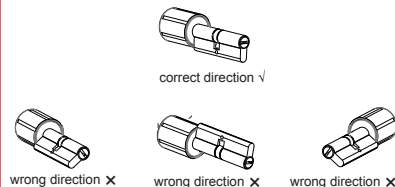

Fig. 3

Step 1. Download App

Download App from App Store or scan QR code below to install Mi App in your mobile



Step 2. Link to Mi gateway

Register your account in Mi App then tap [+]
icon in the upper right corner of main page to
start to link Mi gateway

Please refer to Mi gateway manual to finish.

Step 3. Adding cylinder in App

1. Remove the fixing screw of the knob cover at the rear of the cylinder (See Fig. 1)
2. Tap gateway icon to enter gateway page
3. Tap "Device" on the top line
4. Tap [+] icon to add child device
5. Tap "Smart Door Lock" icon
6. Press down beige button on the cylinder until a long beep heard then release the button
7. Click beige button to check if gateway linked to cylinder successful, otherwise repeat above again
8. Restore knob cover

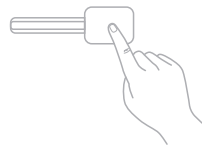

Step 4. Install cylinder into lock

1. Install the cylinder into the lock and make sure the cylinder works properly
2. More details of cylinder replacement, please scan QR code below for reference



This device complies with part 15 of the FCC rules. Operation is subject to the following two conditions (1) this device may not cause harmful interference, and (2) this device must accept any interference received, including interference that may cause undesired operation.

54*85mm

Daily operate manual

- In the cylinder page of the App, all operation record will be listed.
- Enter other function page by tap [...] in the upper right corner of the cylinder main page.
- The "Auto" setup process is same as other gateway child devices.
- In the "key management" page, you can add the key by tap the [+] in the upper right corner. Confirm and insert the key according to the prompt of the App. When you heard a "beep", pull out the key and complete the registration. The key can be renamed after being added.
- In the "key management" page, you can report the loss of the key by sliding the green button from right to left (the color will turn from green to grey accordingly). After the loss is reported, the key cannot be used to unlock; if you need to recover the lost key, just slide the gray button back towards the right side. When the color of the button changes from gray into green, the key can be used to unlock again.
- In the "key management" page, press and hold the key (slide the key to the left if you are using an IOS system), and a window will pop up automatically where you can rename, delete, and set the temporary key.
- The difference between loss of key and deletion of key, Loss of key can be restored at any time, but if the key is deleted, it must be re-registered before being used again

- A temporary key is a key whose unlocking time period can be set in the next 24 hours. It will not usable beyond this time period; the temporary key can also be restored to be a regular key, and its recovery setup is the same as described in item 6
- Enable / Disable local operation. Through the setting on App, you can enable/disable the function of the two buttons on cylinder
- Turn on/off the unlocking prompt tone. Through the setting page in the App, you can turn on/off the unlocking prompt tone
- About prompt tone
 - When the key is inserted into the cylinder, there will be a prompt tone "beep", indicating successfully unlock;
 - If an unregistered key is inserted, there will be an alarm tone from the cylinder;
 - After unlocking, if the key is not turned within 5 seconds, it will be determined that the key is forgotten to be removed, and a warning tone of 30 seconds will start;
 - If the registered key is repeatedly registered, there will also be a prompt tone as an indication of failed registration

Local operation

The cylinder supports the local add / delete of keys as well. Please note that ALL key will be deleted in local mode, can not delete 1 key. To proceed with the local operation, you should first remove the knob cover at the rear of the cylinder. (See Fig. 1)

Note: The mobile allows either the enable or disable of local operation through the App. The local operation can only be performed when authorized by the mobile.

- Addition of keys:** Click the cylinder **【blue button】** to enter the key addition mode (2 beeps); insert the unregistered key into the cylinder and a sound of "beep" indicates that the key is added successfully. Click the **【blue button】** again to exit the mode or exit automatically after 15 seconds (3 beeps).
- Deletion of keys:** (*Use this function with caution*) Press and hold the **【blue button】** for more than 5 seconds until a long beep can be heard from the cylinder. Release the button and ALL key in the cylinder will be deleted.
- The local operation can be synchronized with the mobile through the "refresh" icon, which can be found on the "key management" page of the App.

Tone manual

Operation	Tone	Indication
Insert key	1 beep	unlock
In key-adding mode, insert the unregistered key	1 beep	successfully added
Replace battery	1 beep	power on
Click 【blue button】 or try to add unregistered keys by the App	2 beeps	enter key-adding mode
Click 【blue button】 again or quit key-adding mode by the App	3 beeps	quit key-adding mode
In key-adding mode, insert registered key	beeps	refused registered key
All illegal operation	continuing short beeps --Alarm mode	stop illegal operation immediately
Press 【blue button】 and hold for 5 seconds	1 long beep	deleted ALL registered key
After unlock	6 long beeps	low battery, replace battery at once
Forgot to remove the key	30 beeps	reminder--remove key immediately

Parameters

Product: Electro-Mechanical Cylinder
Style: Euro-profile cylinder
Model: A6121

Contains: cylinder, 5 key, anti-drill cover, screw key duplication & warranty card, user manual
Voltage requirement: DC4.5V
Battery requirement: LR1 AM5 Size N 1.5V
Wireless connection: Zigbee
Temperature requirement: - 25 °C ~ + 55 °C
Humidity requirement: 5% ~ 93% RH

Maximum number of keys registered: 20 Pcs
Product materials: 304 stainless steel, brass, nickel-silver, ABS
Packing dimensions: 225 x 155 x 50 mm
Standards: GB16796-2009; Q/ WM001-2016
Suitable for door thickness range: 45-90mm (depending on the eccentricity of the lockcase)



Warranty

- Within 7 days of reception of the product, the product shall returned or exchanged only if it's not installed. The condition of the product should not affect resale.
 - Within 15 days after reception of the product, replacement or free maintenance services can be arranged if there is performance failure.
 - Within 12 months of date of reception, free maintenance service can be provided for the products with quality issues.
- Warranty services will not be provided after**
- Unauthorized maintenance, misuse, collision, negligence, misuse and injection, oil inlet, accident, modification, incorrect use of non-product parts.
 - The warranty has expired.
 - Damage caused by force majeure.

Service Line: +86 400-887-9017
Manufacture: WIMA Technology (Zhuhai)Co.,Ltd.
Address: 99,University road,Tang jia town,Zhuhai, Guangdong province, P.R.CHINA

FCC Warning Statement

Changes or modifications not expressly approved by the party responsible for compliance could void the user's authority to operate the equipment. This equipment has been tested and found to comply with the limits for a Class B digital device, pursuant to Part 15 of the FCC Rules. These limits are designed to provide reasonable protection against harmful interference in a residential installation. This equipment generates uses and can radiate radio frequency energy and, if not installed and used in accordance with the instructions, may cause harmful interference to radio communications. However, there is no guarantee that interference will not occur in a particular installation. If this equipment does cause harmful interference to radio or television reception, which can be determined by turning the equipment off and on, the user is encouraged to try to correct the interference by one or more of the following measures:

- Reorient or relocate the receiving antenna.
- Increase the separation between the equipment and receiver.
- Connect the equipment into an outlet on a circuit different from that to which the receiver is connected.
- Consult the dealer or an experienced radio/TV technician for help.