

25 Tubular Motor with Built-in Li-battery Instruction

Electronic type
ZH25EL-A1.0ER9



ZM25EL

Li-battery, Electronic radio, Built-in receiver Type

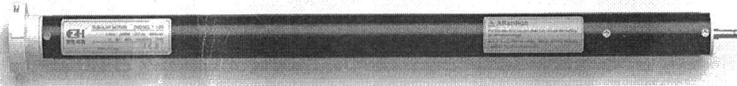

- Super silent design
- Smart home connection
- Power off and position memory function
- Third position limit
- Wireless control:
RF remote, ZigBee, Bluetooth
- Inching / continuation move mode
- Built-in lithium battery

Product model	Input voltage	Rated power	Max current	Battery capacity	Torque	Rated RPM	Running noise	Max load (use with 38mm tube)
ZM25EL-1.1/25	DC5V	8W	1A	3000mAh/7.4V	1.1N.m	25RPM	35-40dB	5KG
ZM25EL-0.8/25	DC5V	8W	1A	3000mAh/7.4V	0.8N.m	25RPM	35-40dB	3KG

Button Manual

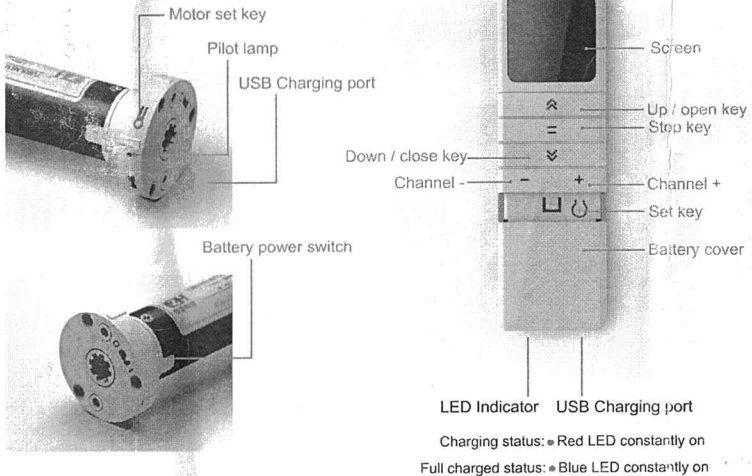

Remote Control Instruction

ZC175A-9 Multi channel remote

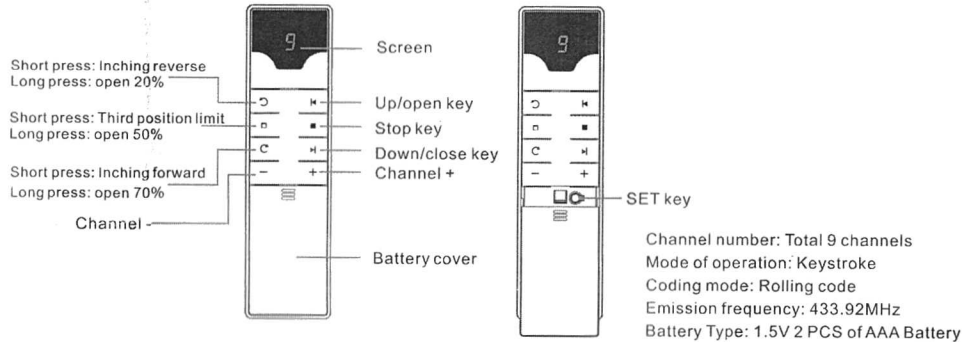

ZC175B-9 Multi channel remote

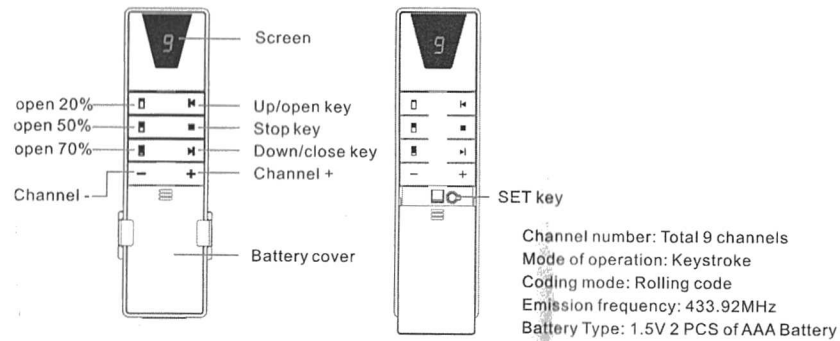

ZC176-1 Single channel remote

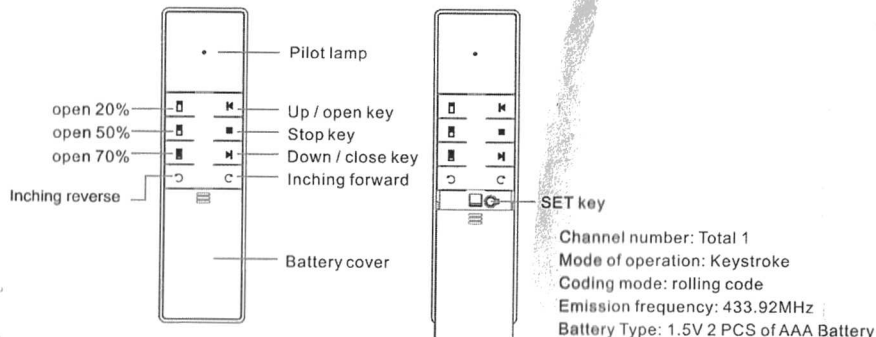

Statement of setting limit

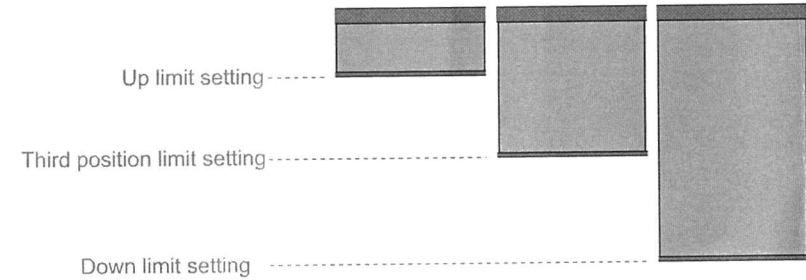

※The up limit and the down limit must be set before the third limit is set, and the third limit will be deleted automatically when the up limit or down limit is deleted.

Charging power supply instructions

Power off: when the switch is on '0'

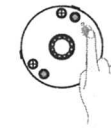

Power switch status: off



Power on: when the switch is on '1'

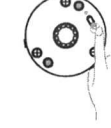

Power switch status: on



▲ LOW BATTERY: The motor will raise an alarm with a sound "DI" to warn low battery. Please charge the device then avoid over-discharge to damage motor or abnormal operation.
Full charge the device for 6 hours before first use.
Please charge the device at least 6 hours for every 3 months to prolong the battery life.

Recharging status: Red light always on when the USB cable plug in power and the motor.
Full recharged: When USB cable plug in power and the motor, fully recharged, the red light on then goes out.

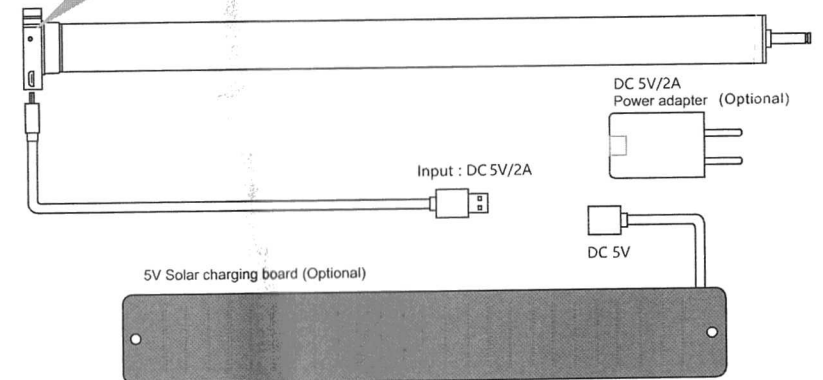

※ When charging the motor, it is necessary to use the factory-configured charging cable to charge.

Operation Instructions

- Press the "Up / open key", the blind up.
- Press the "Down / close key", the blind down.
- Press the "Stop key", the blind stop running.
- Long press the "Stop key" for 3 seconds, the blind automatically runs to third position (Only works when the third position limit is set).

Notice

1. Avoid direct sunlight, outdoor or high-temperature uses.
2. Do not strike or drop any parts; do not disassemble or maintain by yourselves.
3. Do not use volatile chemicals (such as diluent or benzene) which may cause fire or other functional problems.
4. Each type of motor match with corresponding transmission boxes. Please do not install devices with external forces.
5. Please connect the wire according to wiring diagram.
6. Water drop is not allowed on the main parts, which may cause electric leakage or fire, even worse for electric shock on users.

Remote Control and Network Setting Manual

▲ These operations only work for the remote control within the effective control distance, and the motor is in the power-on state, otherwise it doesn't work.

Connection setting for motor and remote control

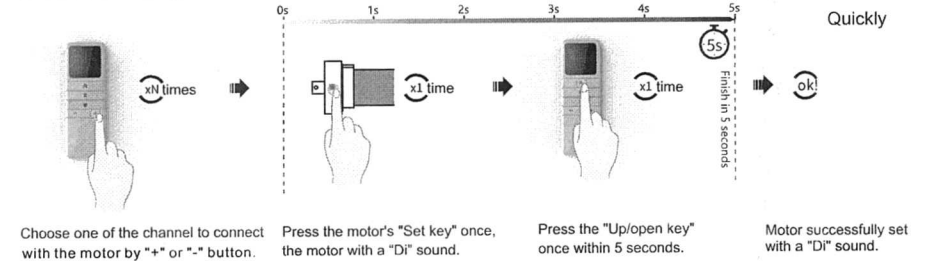

To add extra or multiple remote

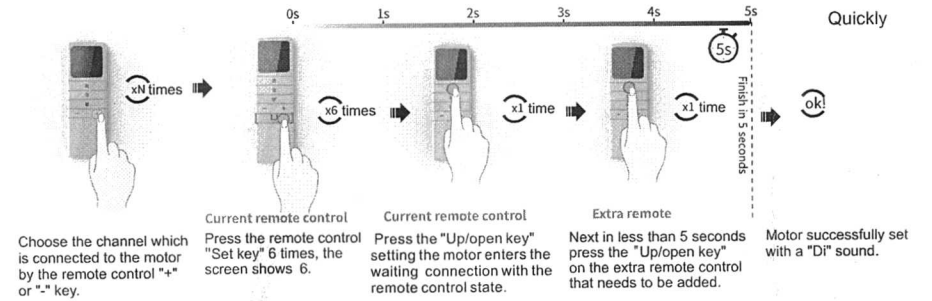

Network configuration of motor (Only for the smart motor)

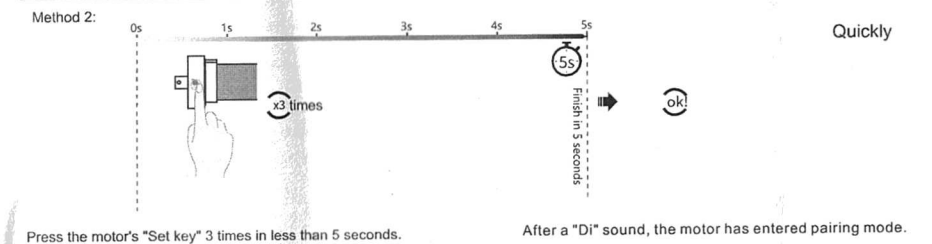
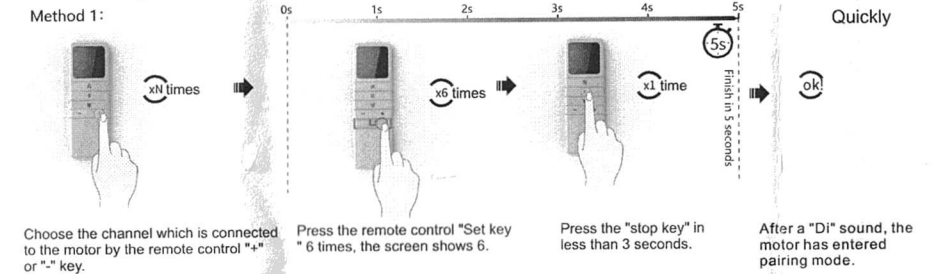

Setting limit

⚠ First running the motor to the limit position you want to set and pause, and then perform the following operations. If the motor has travel limit already, you need to clear the original travel before reset it.

Up limit setting

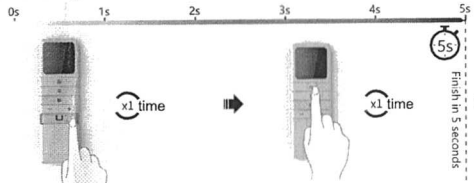

Quickly

Press the remote control "Set key" once, the screen shows 1.

Press the "Up/open key" in less than 3 seconds.

Motor successfully set with a "Di" sound.

Down limit setting

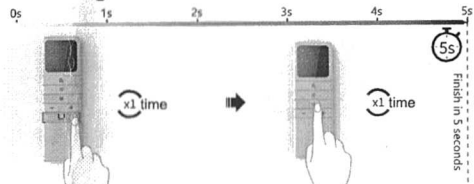

Quickly

Press the remote control "Set key" once, the screen shows 1.

Press the "Down/close key" in less than 3 seconds.

Motor successfully set with a "Di" sound.

Third position limit setting

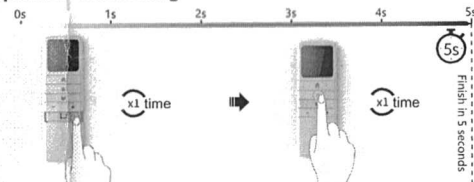

Quickly

Press the remote control "Set key" once, the screen shows 1.

Press the "Stop key" in less than 3 seconds.

Motor successfully set with a "Di" sound.

Remove limit

⚠ You can delete the limit at any position.

Delete up limit

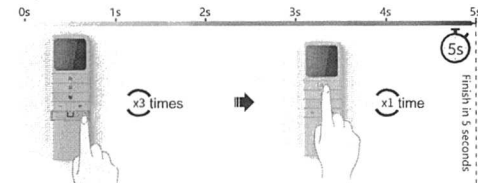

Quickly

Press the remote control "Set key" 3 times, the screen shows 3.

Press the "Up/open key" in less than 3 seconds.

Motor successfully set with a "Di" sound.

Delete down limit

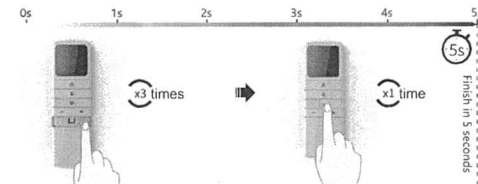

Quickly

Press the remote control "Set key" 3 times, the screen shows 3.

Press the "Down/close key" in less than 3 seconds.

Motor successfully set with a "Di" sound.

Delete third position limit

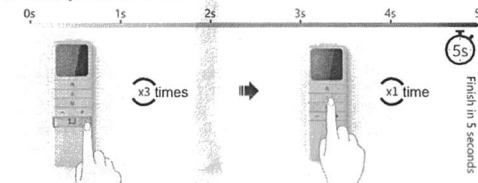

Quickly

Press the remote control "Set key" 3 times, the screen shows 3.

Press the "Stop key" in less than 3 seconds.

Motor successfully set with a "Di" sound.

The limit back to factory mode (Delete all the limits)

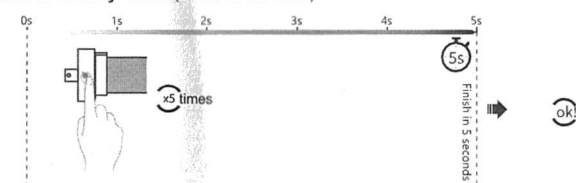

Quickly

Press the motor's "Set key" 5 times in less than 5 seconds.

Motor successfully set with a "Di" sound.

Other functions

⚠ The following functions can be set as personal needs.

Change the remote control direction ⚠ When the control direction is opposite, the remote control can be used to switch the direction, and you can repeat the operation to switch.

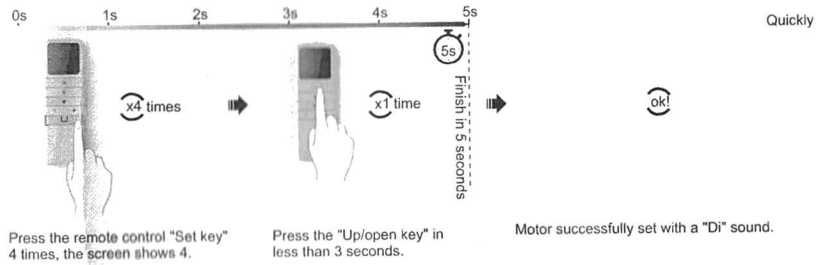

Inching or continuation move action ⚠ When the inching action is needed, perform the following operations. (Repeat this operation can switch back to the continuation move mode.)

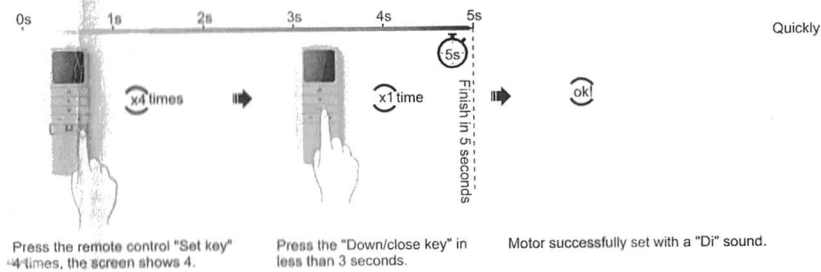

Lock or open the remote channel ⚠ If you need to hide the extra channels, you can perform the following operations. (Repeat the operation to unlock channel.)

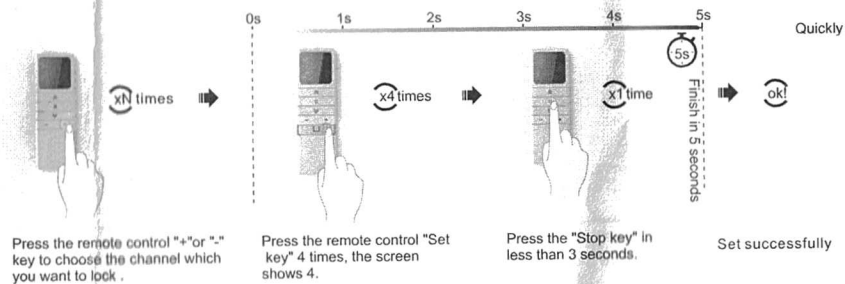

Lock the channel: Do this operation when you have chosen the channel which you want to lock.
Open the channel: Do this operation whatever any channel.
(Repeat this operation for lock or open the channel.)

Delete the remote control from the motor

⚠ These operations only work for the remote control within the effective control distance, and the motor is in the power-on state, otherwise it doesn't work.

Delete the remote current channel from the motor

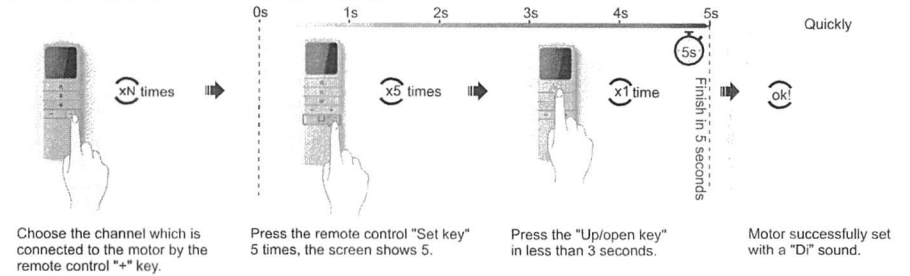

Delete current remote from the motor

To cancel the connection between the motor and current remote all channels.

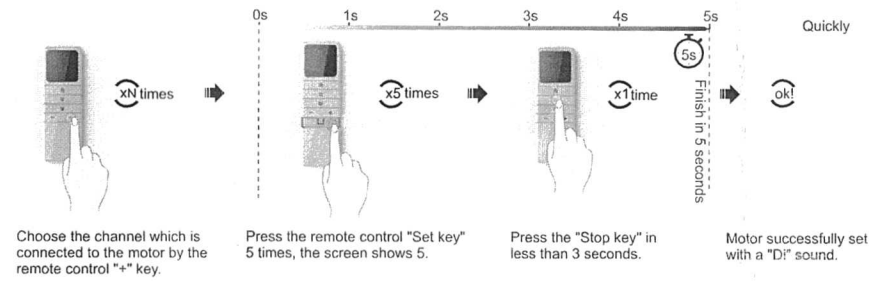

Delete all remote control from the motor

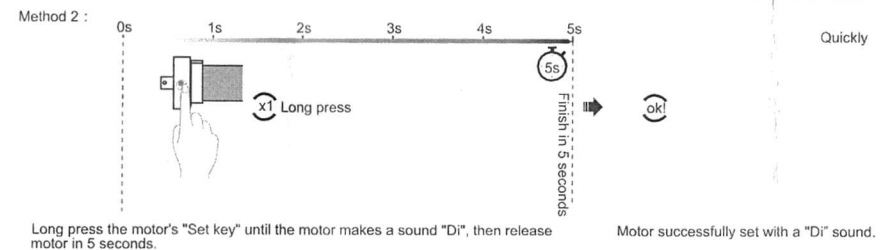
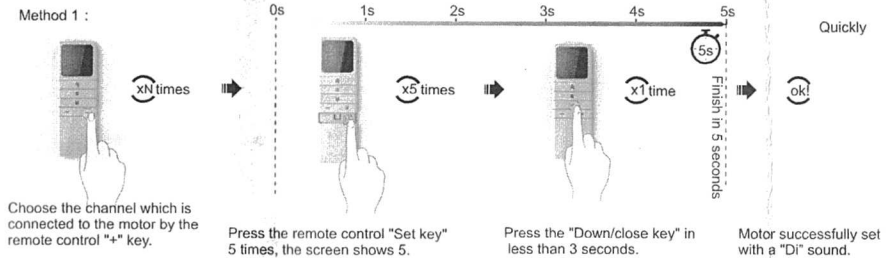

App User Manual (Zigbee / Bluetooth version motor)

Network configuration of motor

1 Download the APP

Scan the QR code as below, or search for "Tuya Smart" in any App store, to download the app. Then please add the Zigbee or bluetooth gateway into App first.



2 Motor enters pairing APP configuration state

⚠ This operation can also be performed when the gateway cannot find the device or the network needs to be reconfigured.

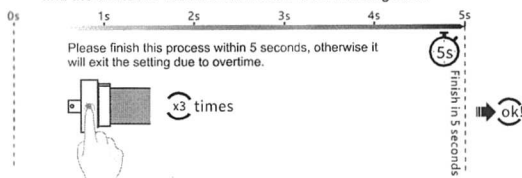

Method 1: In the case of power on, please press the motor Set key 3 times in 5 seconds. The motor will make a sound "Di", waiting for connect with the App.

Method 2: Or pressing the remote control "Set key" 6 times the screen shows 6, then continue to press the "Stop key" once time quickly in less than 5 seconds, the motor will make a sound "Di". Now it is waiting to be connected with the App.

If the configuration fails reconnect once time.

(The premise of using method 2 is that the remote control has been connected to the motor.)

3 App setting

⚠ Please follow these steps to configure the motor.

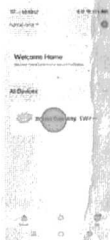

1. Enter the homepage then choose the Zigbee gateway which you want to connect.



2. Under the zigbee page, press "Add subdevice".



3. The App will now search for the device and register to your account. Choose the curtain motor to connect, then reset the Device Name.



4. Back to the Zigbee page, choose the motor which you just added.



5. Enter the motor control page, now you can control the motor by App as well. Enter the motor setting page, can be set the motor limit, timing control, changed the motor direction, and so on.



6. On the motor control page, click "Z" in the upper right corner to enter the motor technical parameter setting page, you can check the device information, change the name, and so on.