

**GENERAL NOTES**

REVISIONS BY  
 1 02.11.07 DC

- THIS PLAN IS FOR DIMENSIONAL PURPOSES ONLY.
- GENERAL CONTRACTOR TO NOTIFY ARCHITECT AFTER LAYOUT IS DONE AND WALL TRACK IS IN PLACE PRIOR TO FRAMING ANY WALLS.
- FOR DIMENSIONING PURPOSES, METAL STUDS ARE DRAWN AT 4" OR 6" U.O.C. AND BLOCK WALLS ARE DRAWN AT 8" U.O.
- 8" BLOCK WALLS AND 6" METAL STUD WALLS ARE DIMENSIONED AT FACE OF WALL AND 4" METAL STUD WALLS ARE DIMENSIONED AT CENTER OF WALL U.O.

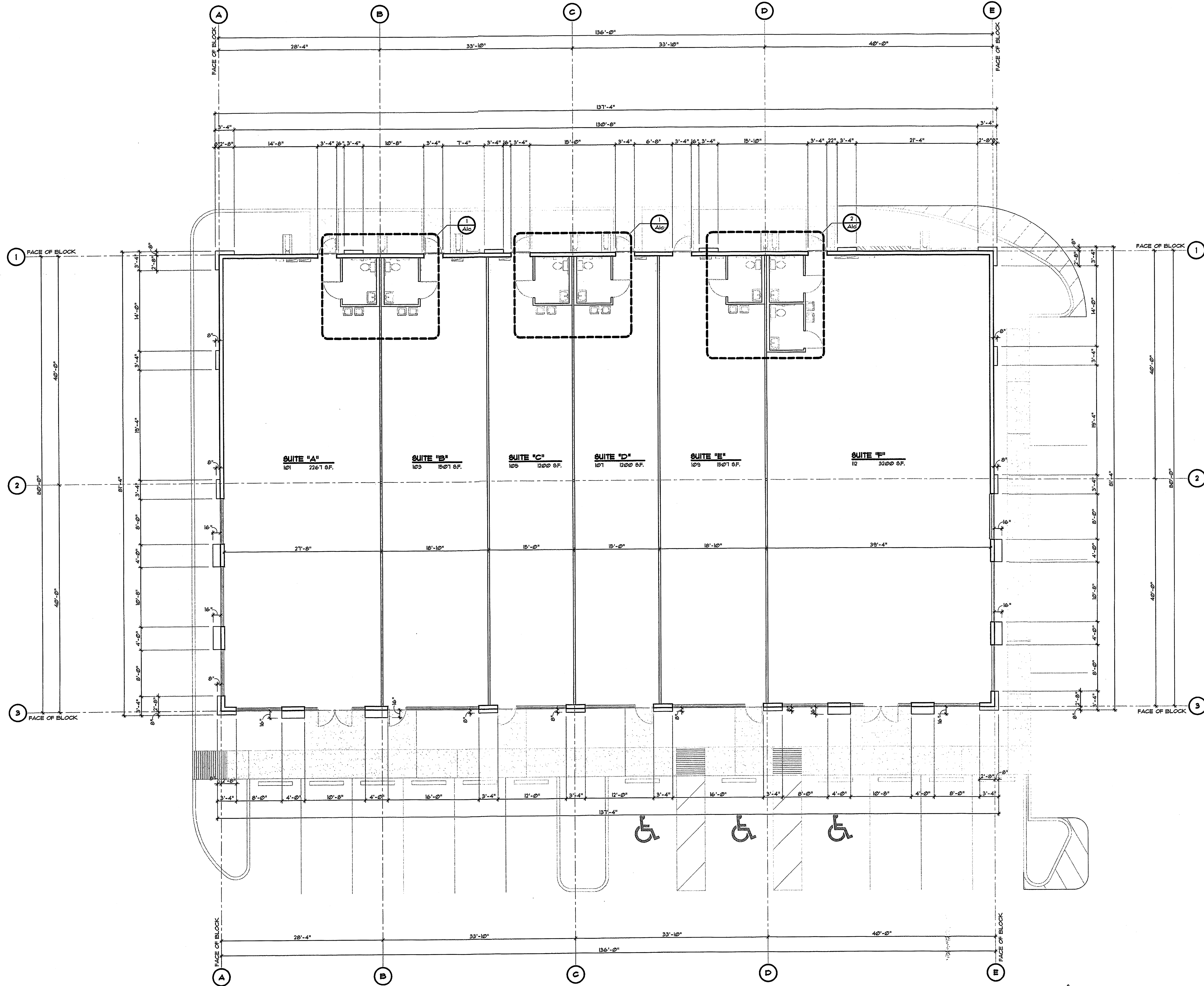

1 DIMENSIONED FLOOR PLAN  
 SCALE: 1/8" = 1'-0"

**OLIVERI ARCHITECTS**  
 AA 000921  
 Member of the American Institute of Architects  
 32707 US Hwy. 19 • Palm Harbor, FL 34684  
 Phone 727.781.7525 • Fax 727.781.6525 • E-mail design@oliveriarch.com

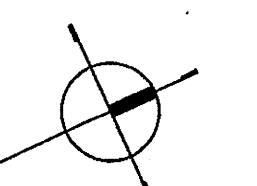
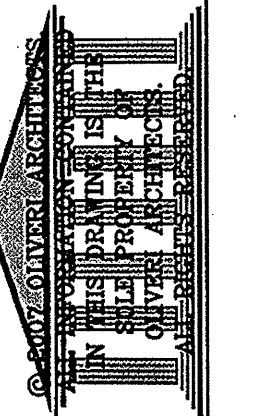

Joseph L. Oliveri, AIA  
 9-20-07  
 A10014028

HERNANDO CO. DEVELOPMENT SERVICES DEPARTMENT  
 Building Plans Review  
 Approved for Use  Not Approved  
 Approved as Noted  Comments Attached  
 This review does not relieve the Contractor from errors or omissions in this submittal or from the Contractor's responsibility for code compliance. These plans have been reviewed for compliance in accordance with the Florida Building Code. The issuance of this permit shall not be held to permit or approve the violation of any law, code regulation or ordinance.  
 Date: 06.11.2007

**A-ZONE**

**JOB COPY**

1211883-

RECEIVED  
 SEP 21 2007  
 HERNANDO COUNTY  
 DEVELOPMENT DEPT.

New Free Standing Retail Center  
**SHOPPES OF SPRING HILL**  
 1859 Commercial Way  
 Spring Hill, Florida

Date: 06.11.07  
 Scale: AS NOTED  
 Project Mgr: GD  
 Drawn: SEH  
 Job: 07-23  
 Sheet

**A1b**