

ETL v7

geometry update

MTD DPG meeting
12th November 2021

Marta Tornago - Università and INFN Torino
Fabio Cossutti - INFN Trieste

ETL v7: updated design

Updated design of the back support plate with notch structure

Cables description in the notch region now included according to description provided by N. Koss

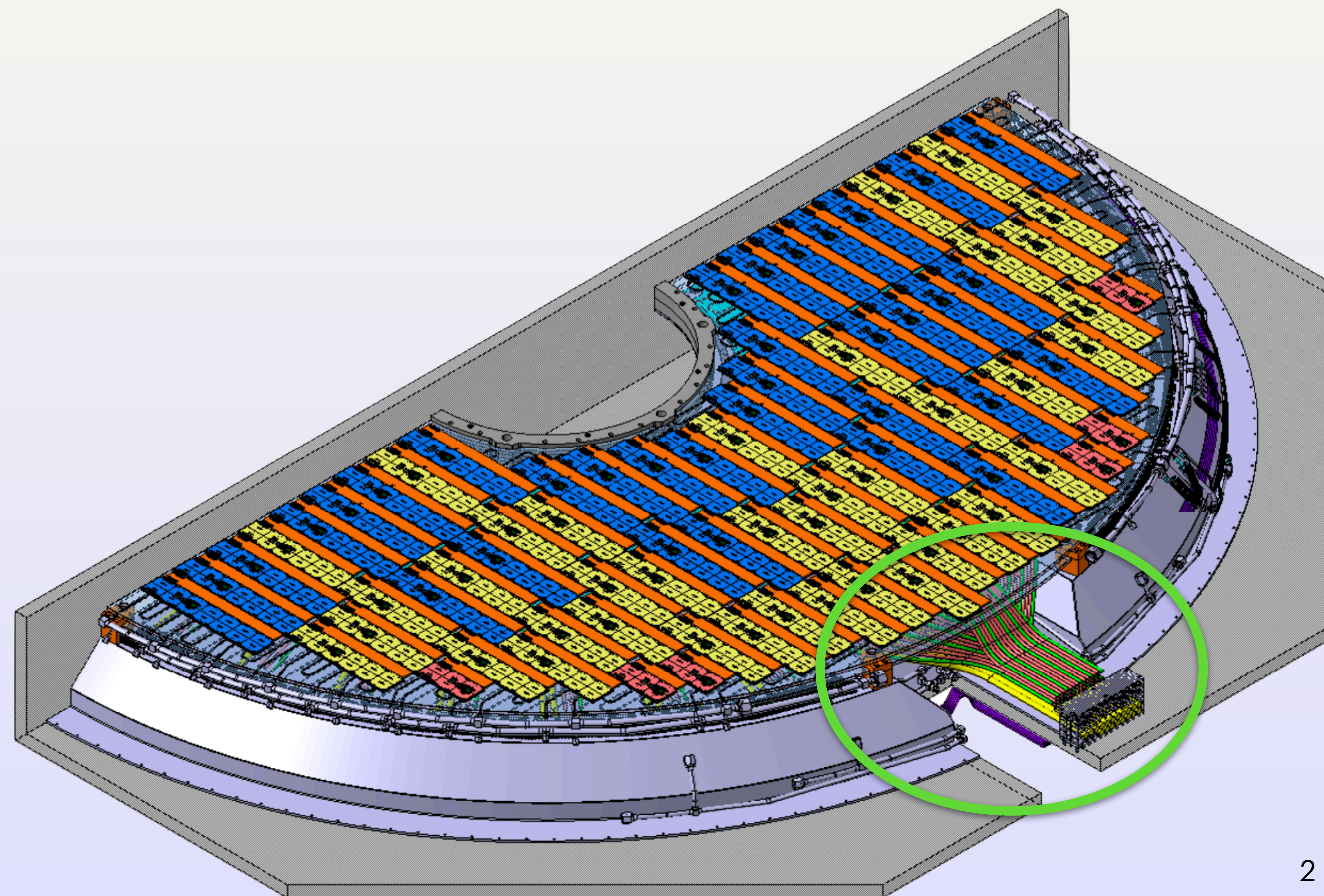
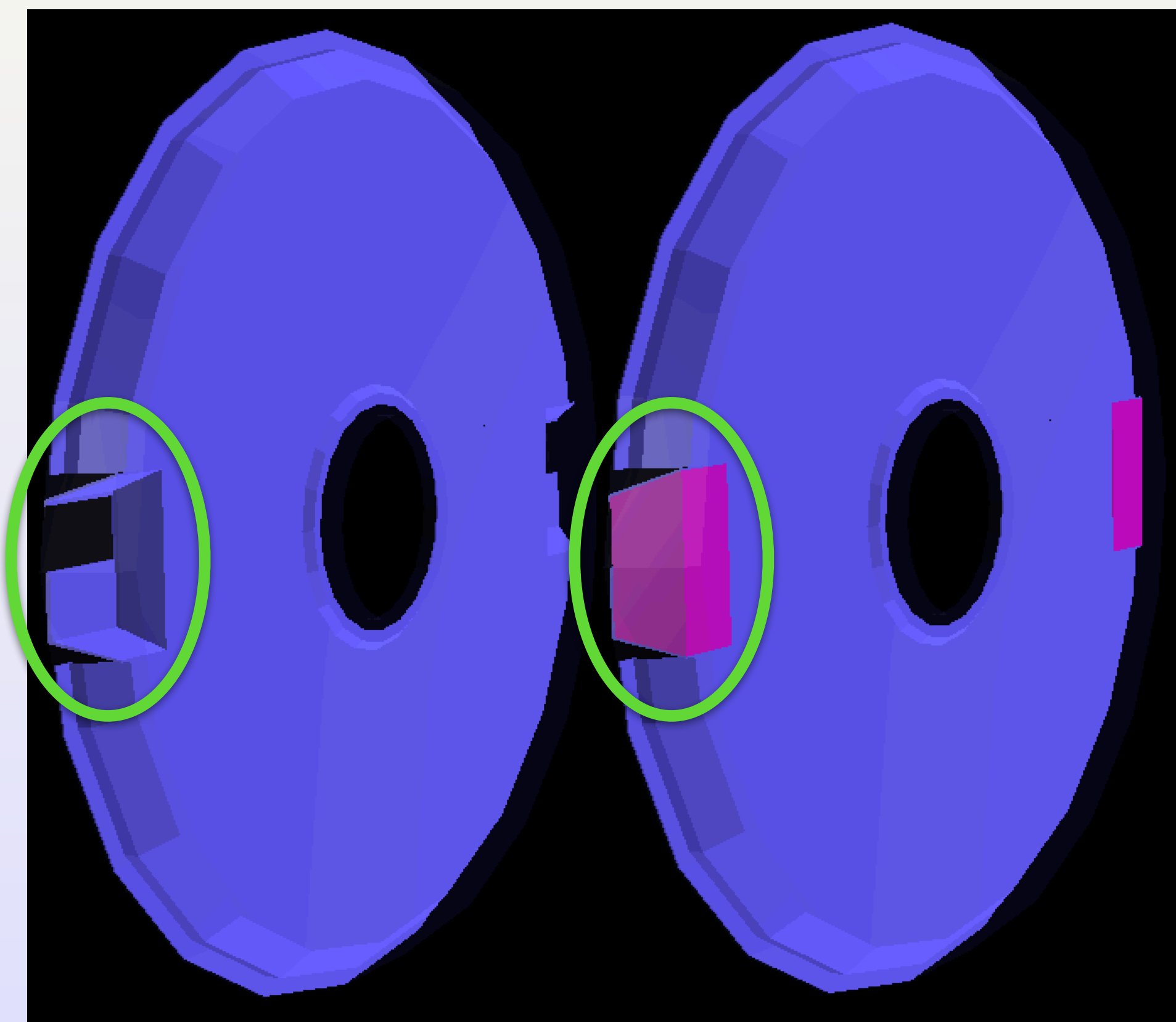

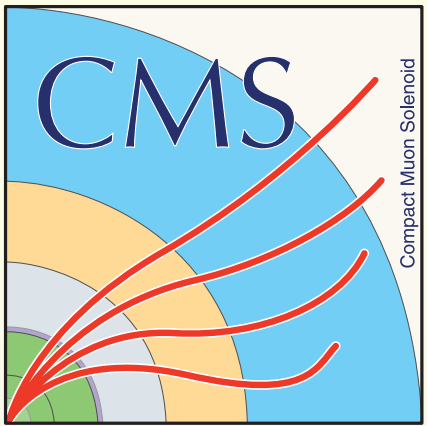

ETL v7: updated design

Overlap with **CALOECTSModerator** in the notch region

SOLVED

A **new CaloECTSModerator volume** has been defined by S. Banerjee using a subtraction volume to host the ETL notch structure

New CaloECTSModerator volume

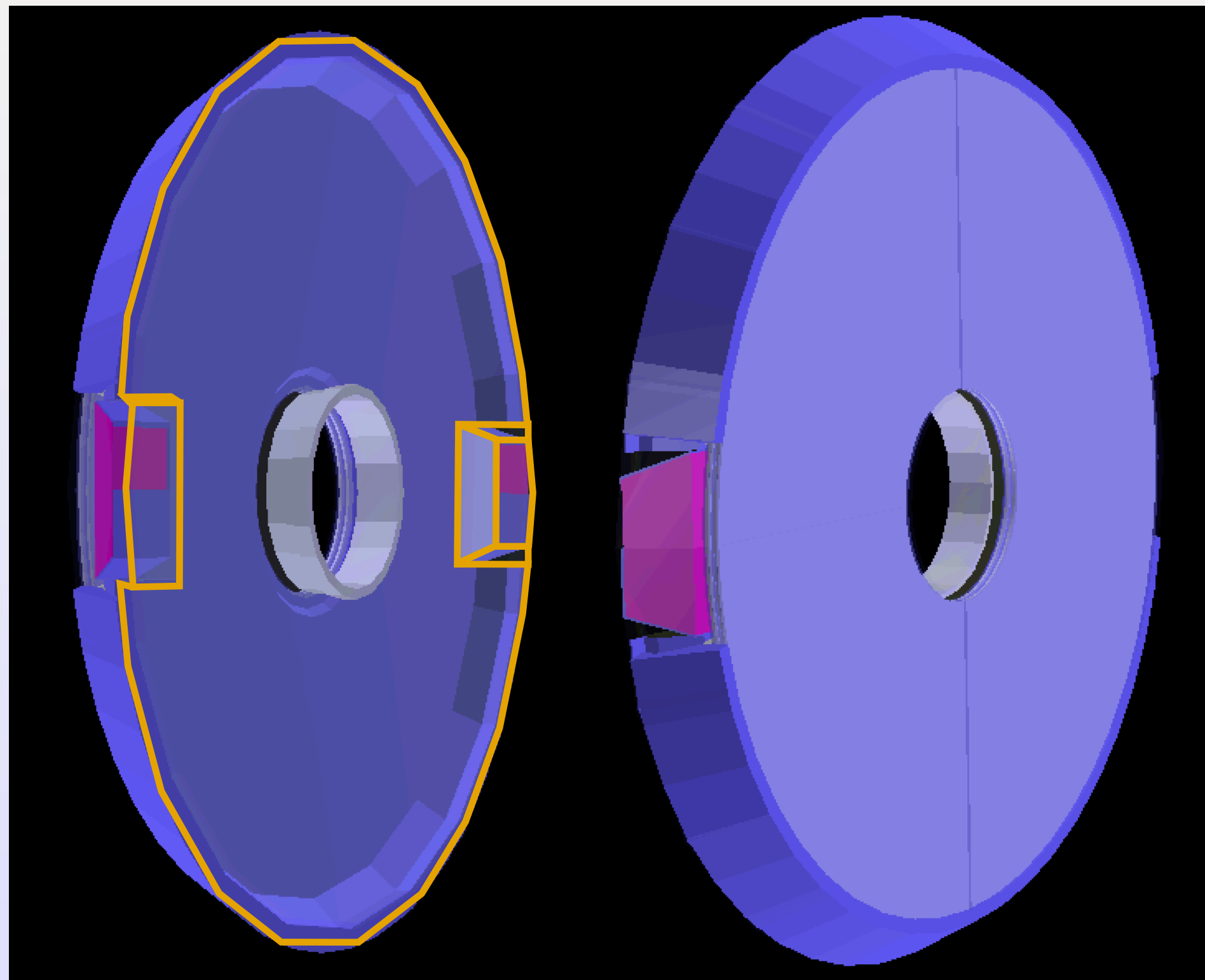
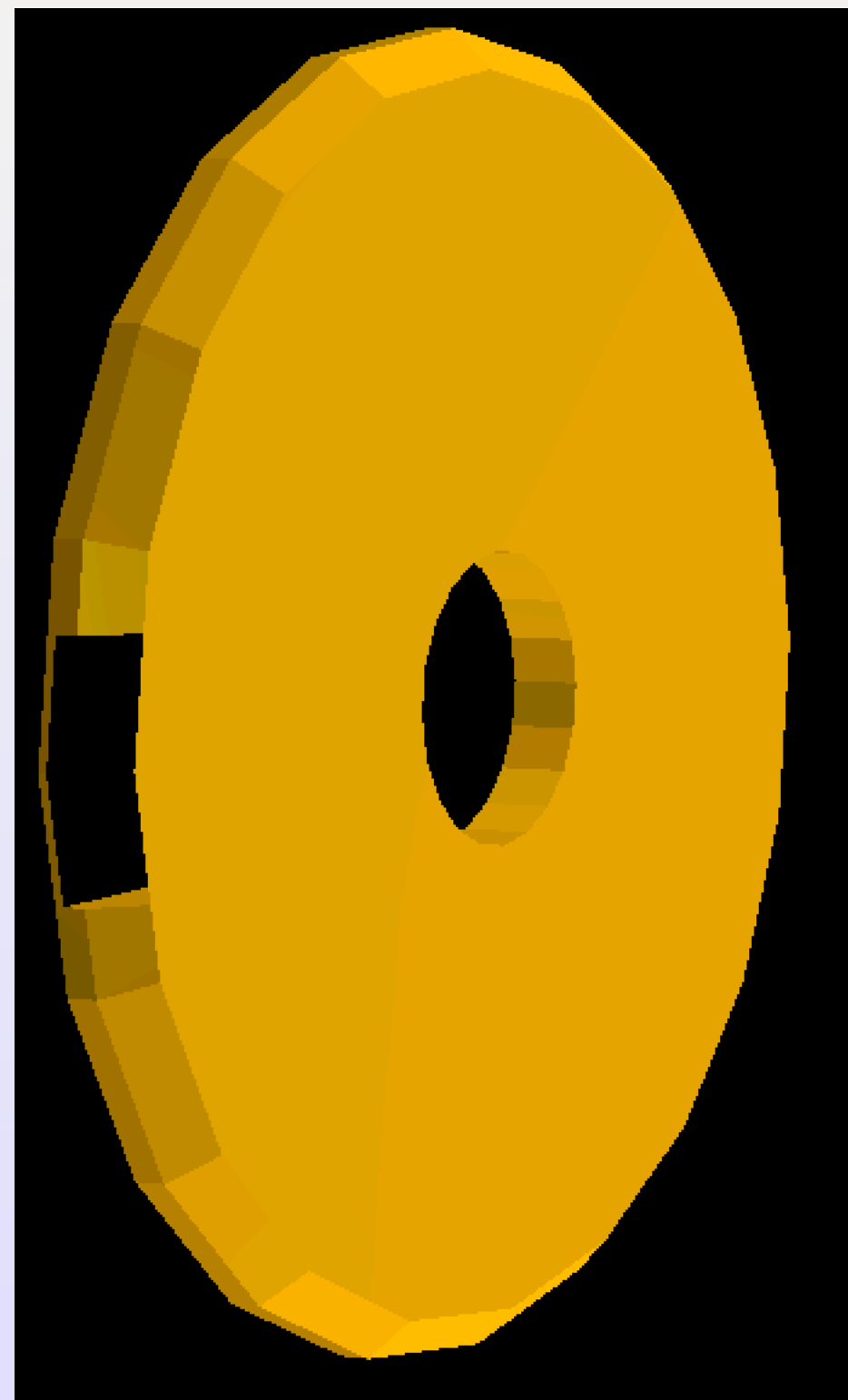

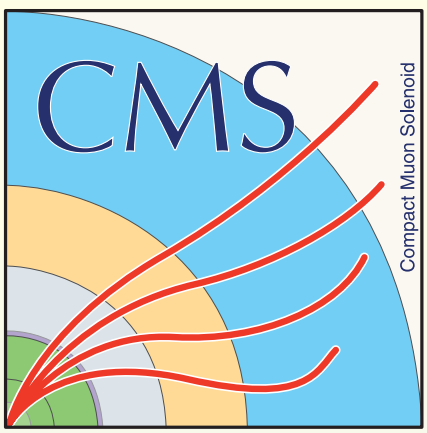

Conclusions and future plans

ETL v7 has been implemented according to the latest ETL drawing updates from end 2020/start 2021 provided by N. Koss. Latest geometry updates include:

- **New definition of the ETL volume** to host all passive layers
- **Updated layout of passive layers** with addition of cooling pipes, cabling and structures refinement
- **Solution of overlaps** with CALOCTSModerator thanks to new caloBase.xml v7

New geometry checked with Fireworks visualisation, g4OverlapCheck and testMTDinDDD

See: [Update ETL passive structure for notch and cables inside, revision of ETL mother volume • Pull Request #36071](#) and [Phase2-gex99 Add a new definition of caloBase.xml to accommodate the notch structure of ETL support by bsunanda • Pull Request #36013 • cms-sw/cmssw \(github.com\)](#)