

BlueGenes Redesign Concept

By Roshni Prajapati

ISSUES IN EXISTING DESIGN

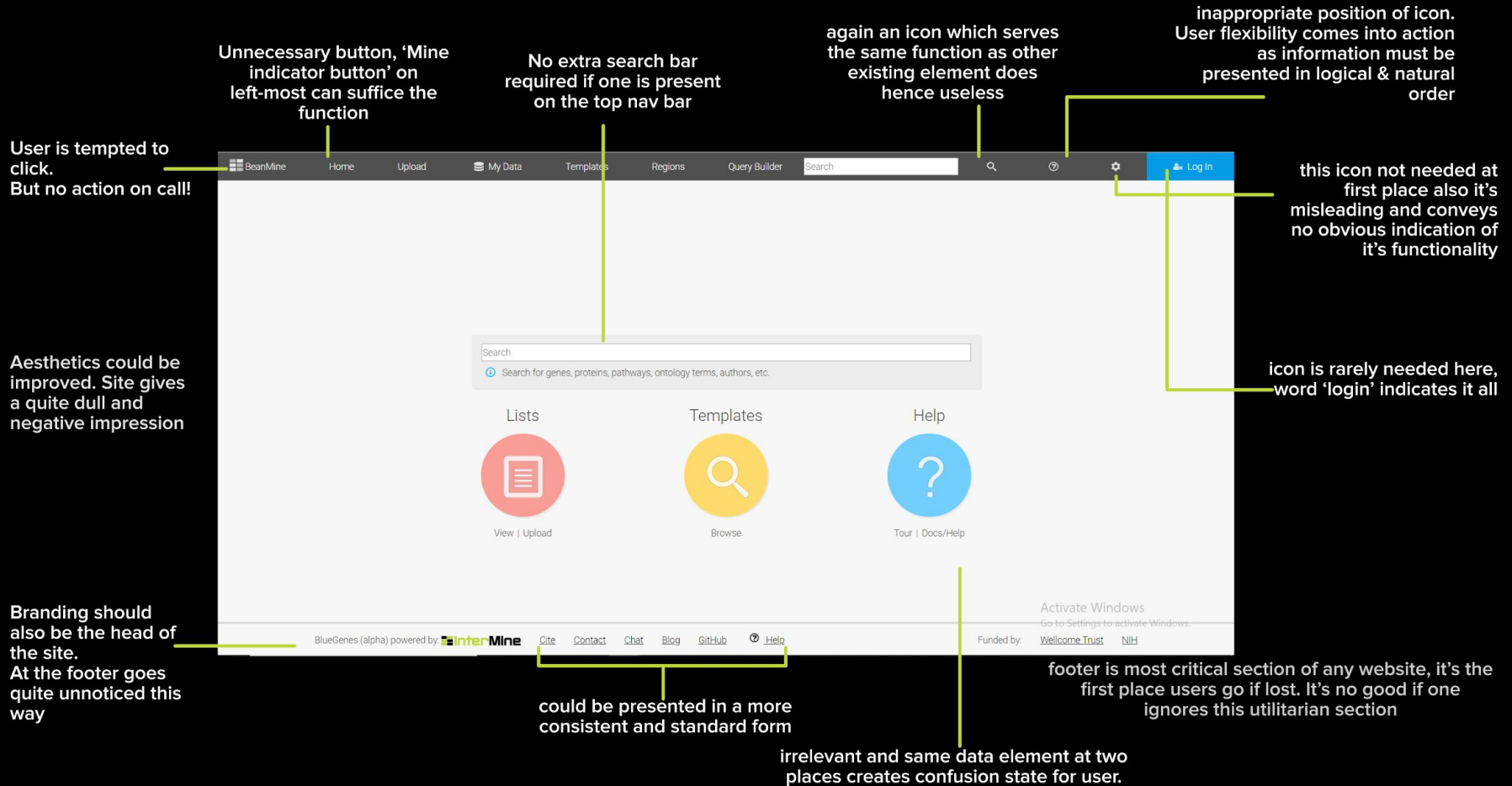

REDESIGN CONCEPT

It is important to mention organization and site base.
We can add extra navbar for that detail, as for every named organization recognition is important

Clearly specifies user for list of mines. No other extra icon required

No home icon required. Clicking on the mine name will suffice. As both serve the same functionality

No icon required, word 'LOGIN' says it all

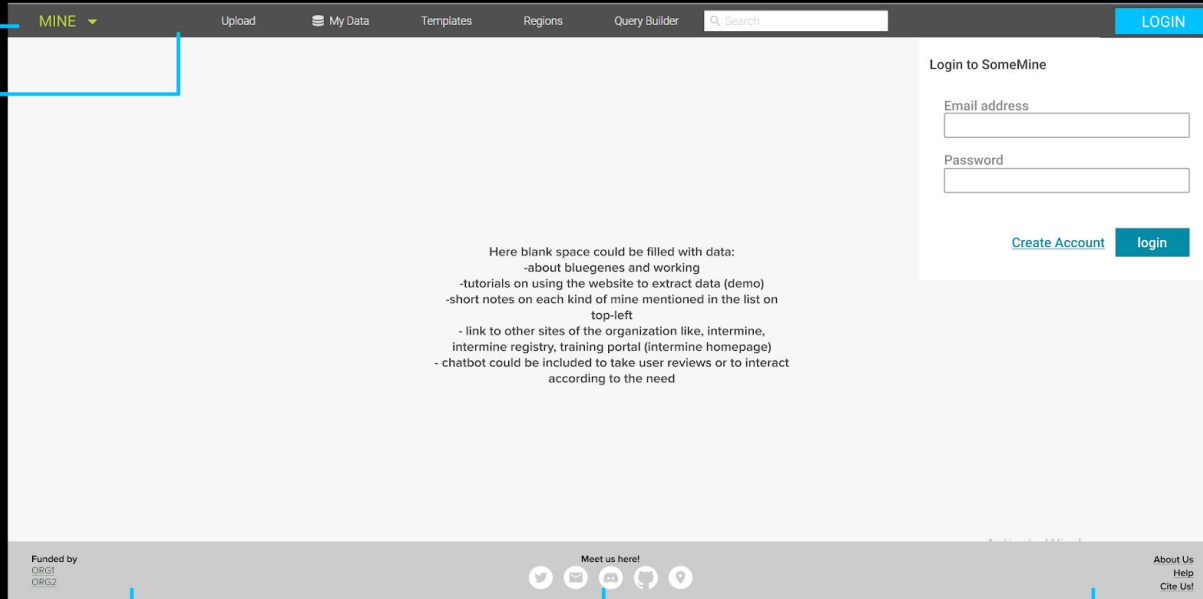

No logo required at login button
Make the actions just and clear
Signify actions 'Create account' rather than making user to think for 'I don't have an account'

Almost of no importance, hence to the least scanned section of footer we can add 'funding' section

Every link presented in form of standard icons, makes it consistent

Informative data about the website shown in separate column on the footer

footer section divided into 3 sections depending on the data to clear out the view for users

ISSUES IN EXISTING DESIGN

Use of the button is ambiguous
(takes to previous page or uploads
a file somewhere?)

BeanMine Home Upload My Data Templates Regions Query Builder Search Log In

Upload Save

Create a new list

Select the type of list to create and then enter your identifiers or upload them from a file.

- Separate identifiers by a comma, space, tab or new line
- Qualify any identifiers that contain whitespace with double quotes like so: "even skipped"

List type
Gene

Organism
C. arletinum

Identifiers are case sensitive

Free Text File Upload

EXAMPLE RESET CONTINUE

BlueGenes (alpha) powered by InterMine Cite Contact Chat Blog GitHub Help

Funded by Wellcome Trust NIH

System must keep users informed what's going on the site, but here no clear specification to the user.

User should not have to remember information from one part of the dialogue to another. Instructions for use should be visible or easily retrievable whenever apt.

Aesthetics could be improved

Wrong use of tabs here. tabs are used for navigation or switching to totally different

REDESIGN CONCEPT

Highlighting the active tab should be properly shown

The screenshot shows a web application interface for creating a new list. The top navigation bar includes 'MINE', 'Upload' (highlighted), 'My Data', 'Templates', 'Regions', 'Query Builder', a search bar, and 'LOGIN'. The main content area is titled '← CREATE NEW LIST' and contains a form with the following fields:

- List type:** A dropdown menu with a placeholder 'Information about this field mentioned here'.
- Organism:** A dropdown menu with a placeholder 'Information about this field mentioned here'.
- Mention identifiers:** A text input field with a placeholder 'Information about this field mentioned here' and a checkbox labeled 'Identifiers are case-sensitive'.

Below the form are four buttons: 'EXAMPLE', 'RESET', 'CONTINUE', and 'SAVE AS DRAFT'. The 'CONTINUE' button is highlighted in blue. The footer contains 'Funded by ORG1 ORG2', social media icons, 'Meet us here!', and 'About Us Help Cite Us!'.

Mentioned which category is required. Keeps user informed at every step

Clearly expresses user to either attach file or input the data. User action is also clear now

the data type for individual fields required in the field is clearly specified

Buttons of less priority separated to fasten the decision making

ISSUES IN EXISTING DESIGN

When number of data is more to be displayed as tabs, horizontal line is not the first option! makes eye wander

Unnecessary button. If user needs to view more his/her instant action would be to click anywhere on the block displaying information

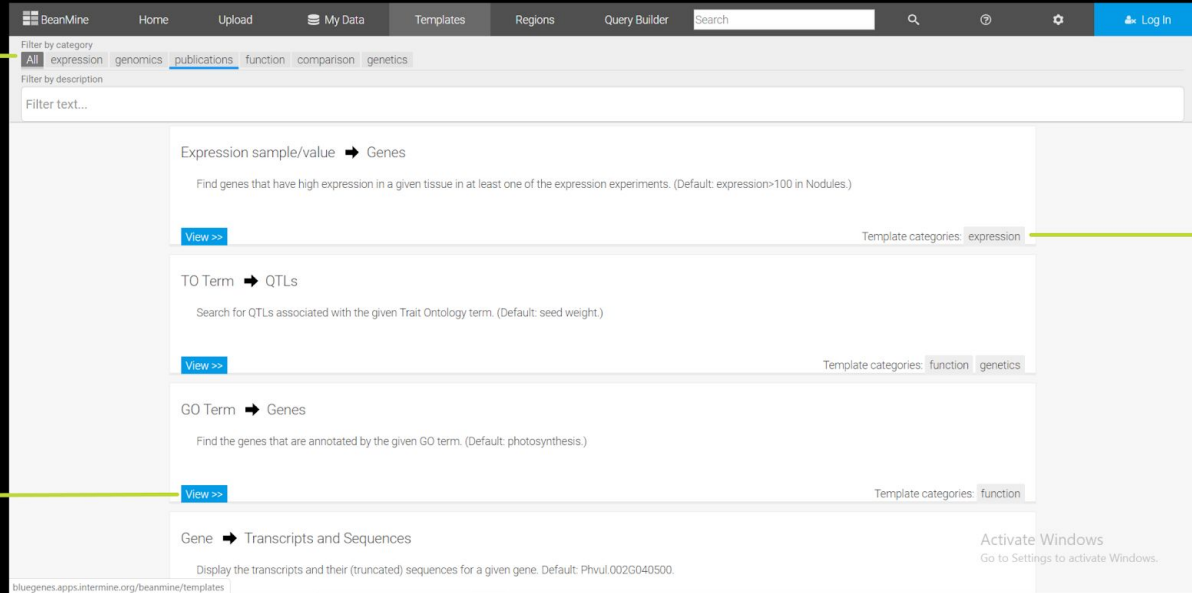

Obvious from category tab what the element, 'template category' is not required

REDESIGN CONCEPT

Highlighting the active tab should be properly shown

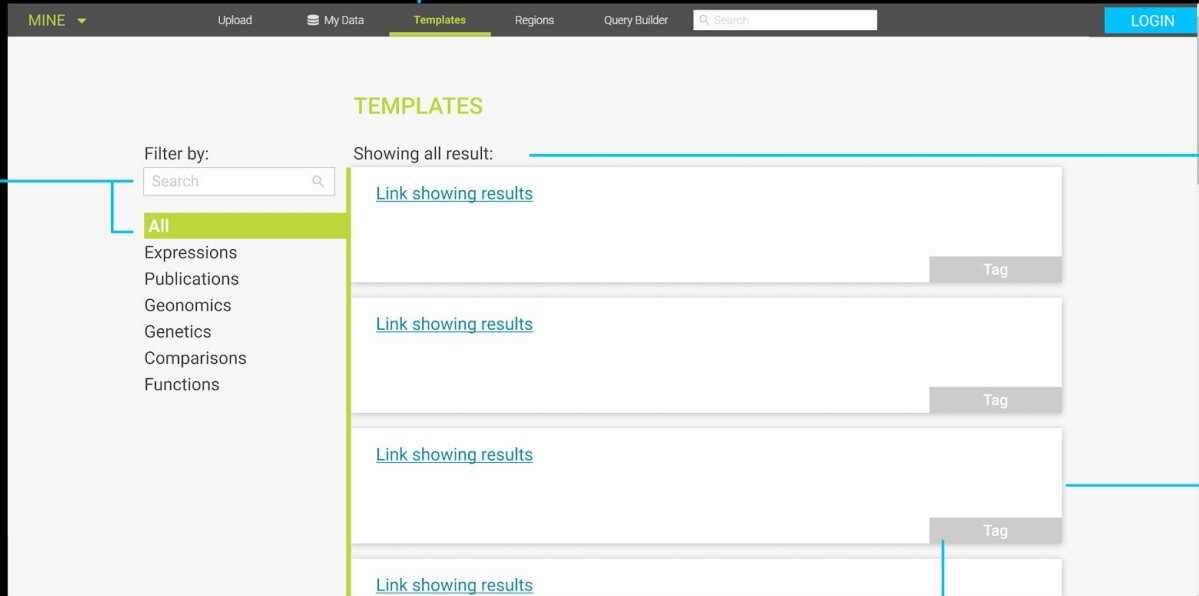

Clear search input along with vertical representation of the tabs makes function clear as well

title makes it clear which result is displayed

If we remove the 'view' button from result cards and make the whole card clickable then shadow signifies that card is clickable

Tag specifies the category is obvious no need to title it as 'template category'

Thankyou