

# Installation Guide for In-Channel Window Visor

[Safety Warning/Caution] 

## Preparation:

- Turn off the engine and put the vehicle in Neutral, lock the handbrake before installation.
- Avoid exposure to extreme heat and high humidity.
- Clean the window area with dry towels or cleaning wipes.
- Professional installation is always highly recommended.



## Step 1:

- We need to trial fit (pre-fit) the window visors onto the window.
- Use 70% alcohol to clean the contact area and the entire window channel. Make sure your window is 100% clean and dry.

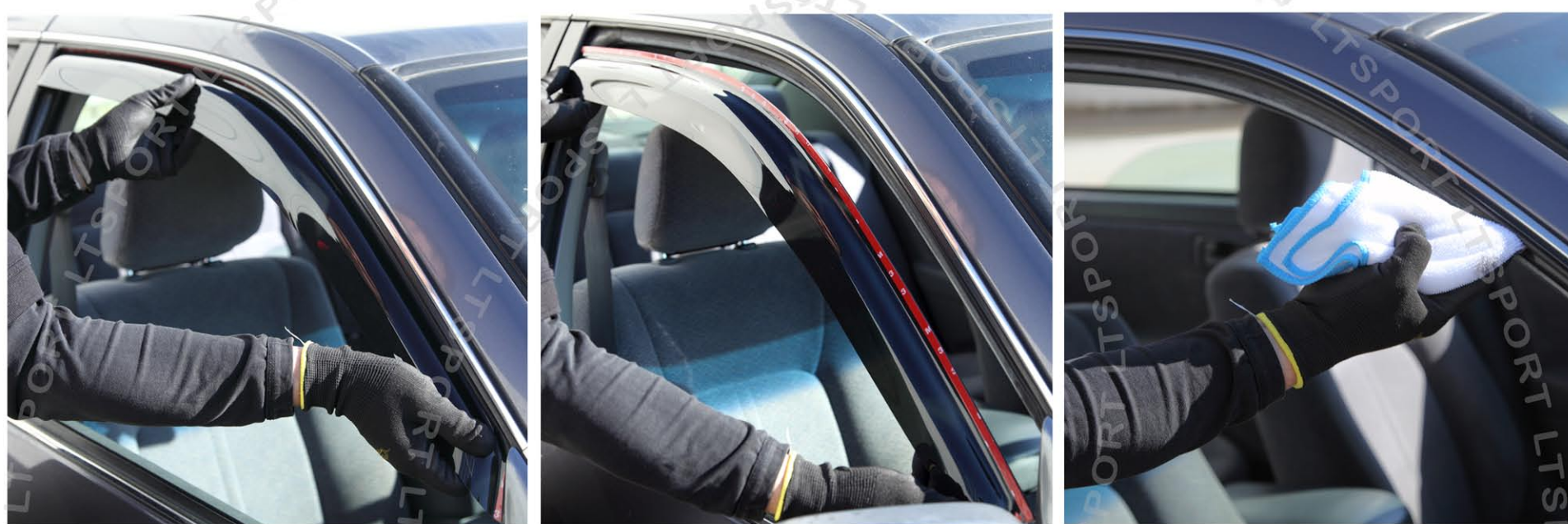

## Step 2:

- Peel off the 3M tape, lift up the mirror cover and insert the visor underneath first, then insert the visor into the channel.



## Step 3:

- Adjust the visor and make sure it lines-up to the window,
- Slowly raise the window without activating the "Auto Up" feature two or three times to make sure the visor works properly.

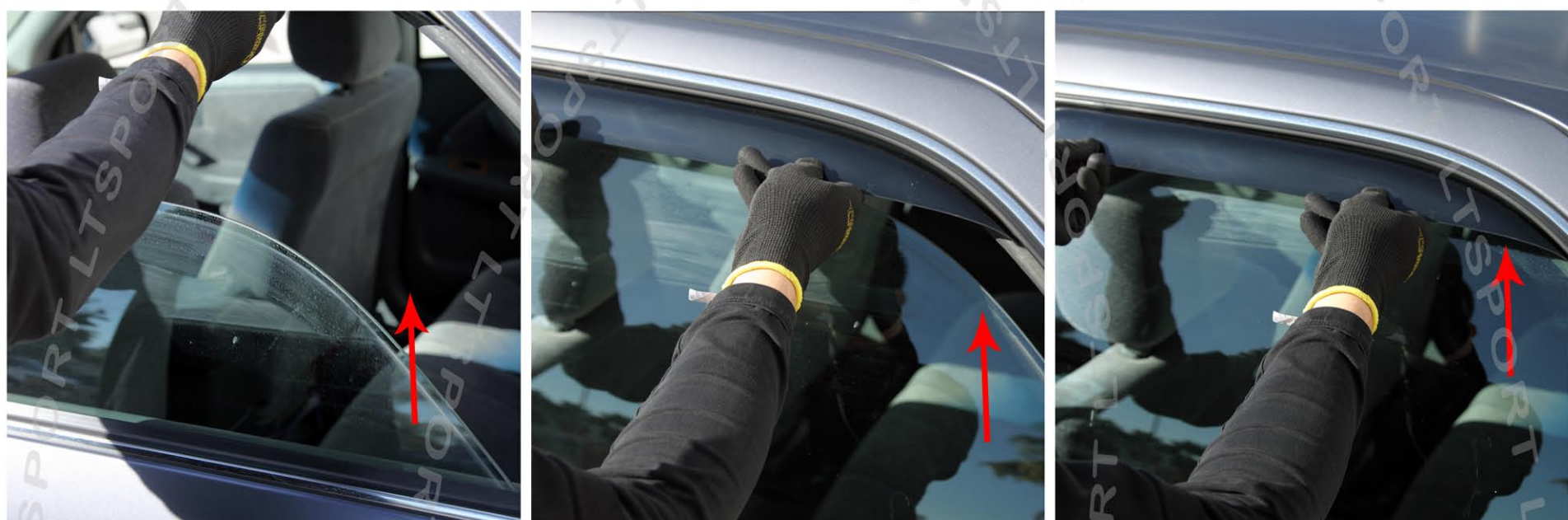

## Step 4:

- Rub over the taped edge of the visor with a dry cloth and apply pressure to secure it into the channel.
- Repeat above steps to the other three door sides.
- Please leave the window visors up for at least 24 hours to help them set in place.



**Finish**