

## Motor set up

### Operating Instructions for Remote Controller with Light Control

#### 1. Function and Features

- 86mm\*86mm, in accordance with international installation standard;
- The electric structure is partial conformity with the standard fire protection requirement of the electrician;
- Industrial grade microcomputer chip is used to improve product quality and reliability greatly;
- Use shock-proof current relay;
- Components using precision SMT industry, surface moisture-proof treatment;
- Power supply has safety protection, power supply time is 5 minutes;
- It is used with various emitters and tubular motors.

#### HC-PM03F\D-T1

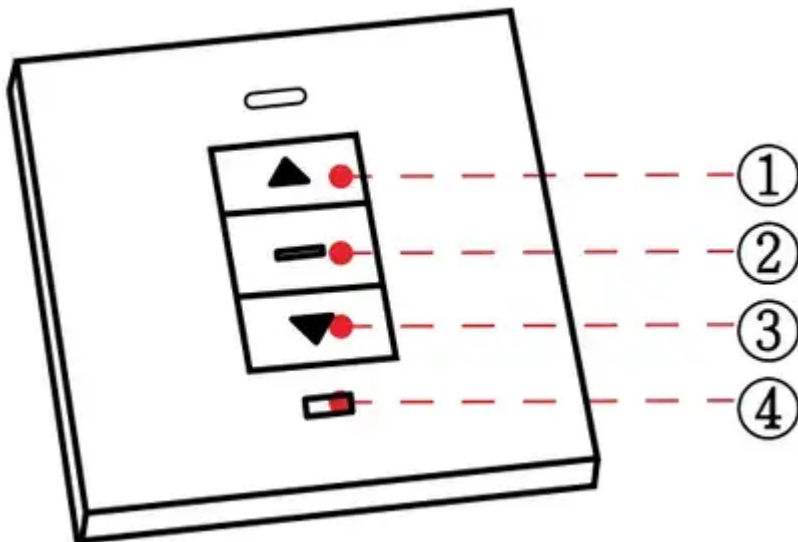

- ① Motor: Up button
- ② Motor: Stop button
- ③ Motor: Down button
- ④ Light bulb: turn on/off button

### HC-PM03\D-T1

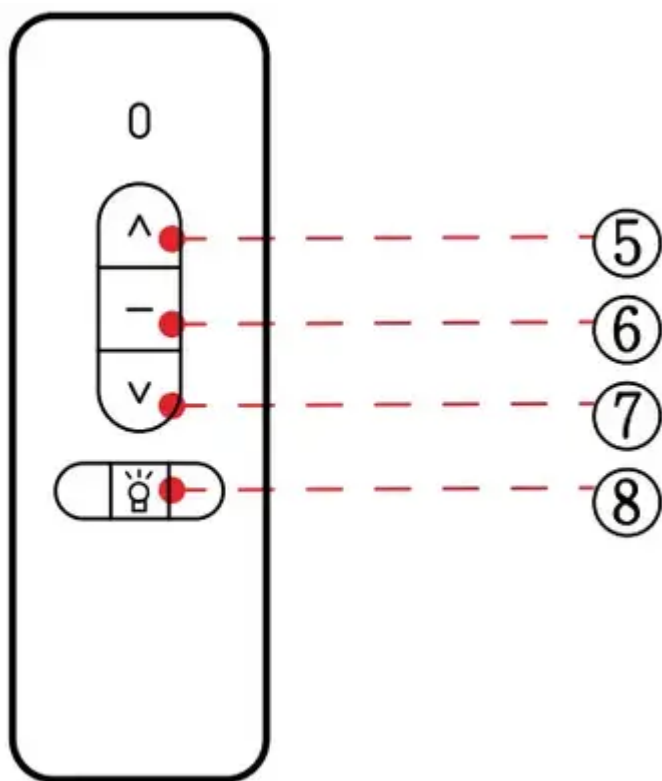

- ⑤ Motor: Up button
- ⑥ Motor: Stop button
- ⑦ Motor: Down button
- ⑧ Light bulb: turn on/off button

### Product Parameters

Product name	Remote controller with light control
Product model	HC-PM03F\D-T1
Receiving/ transmitting frequency	433.92MHz
Working temperature	-20°C~+85°C
Receiving sensitivity	-110dBm
Allowed number of transmitters	S8pcs

Product name	Remote controller with light control
Product model	HC-PM03\D-T1
Receiving/ transmitting frequency	433.92MHz
Working temperature	-20°C~+85°C
Receiving sensitivity	-110dBm
Allowed number of transmitters	S8pcs

## Operating Instruction

### A. Learning code

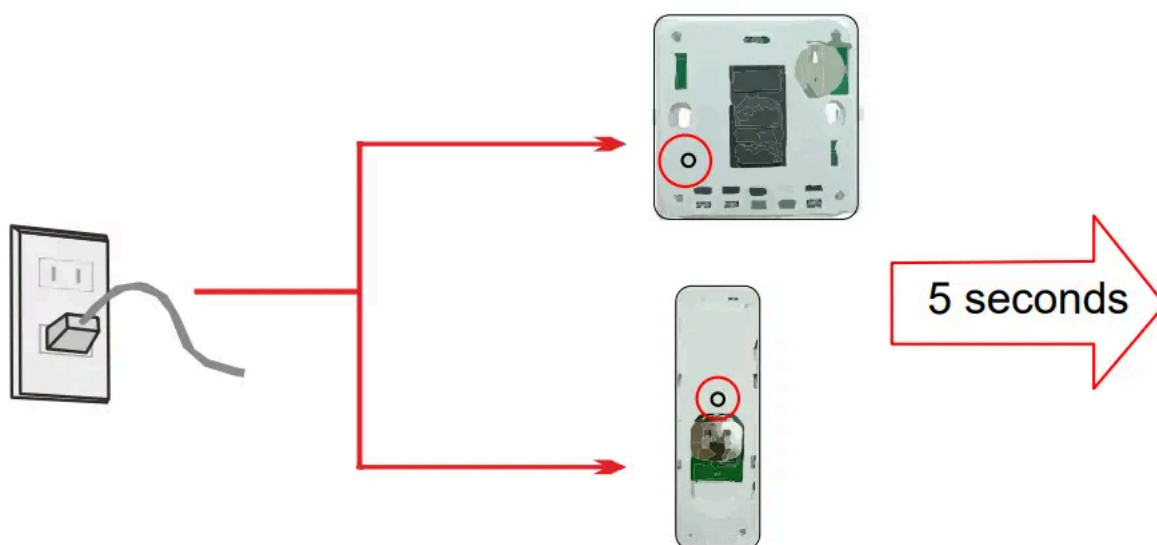

#### 3-1

Must unplug over 10 seconds before plug in



#### 3-2

\*Within 7 seconds after plug in or power on\* Open the back cover of the remote control and press and hold the code key for more than 5 seconds with a fine needle.

**3-3**

When the motor keeps beeping "dididi".

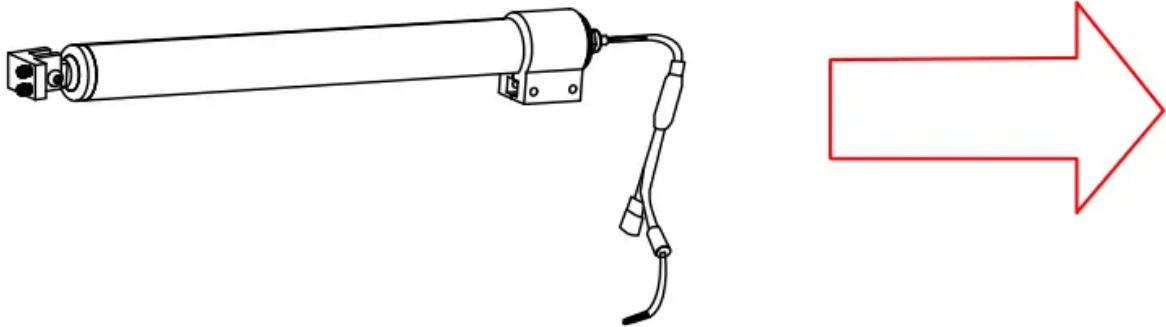
**3-4**

Press the "up button" of the remote control once and hear the beep of the motor, and the code matching is successful.

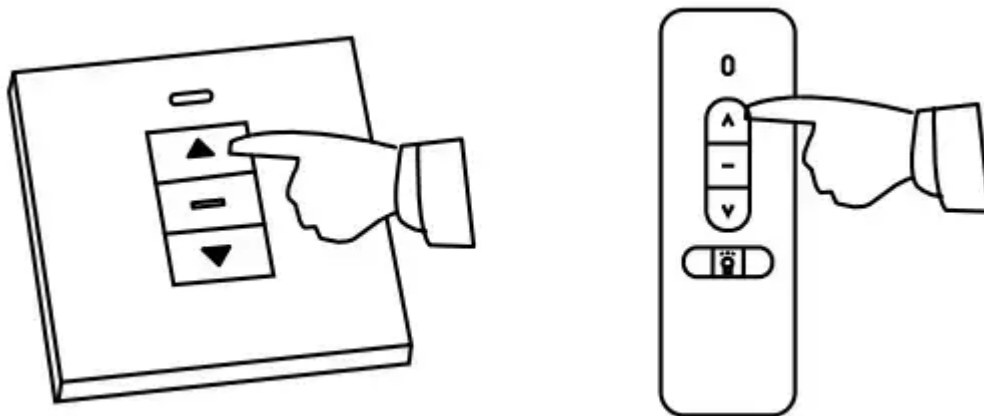
**B. Deleting code**

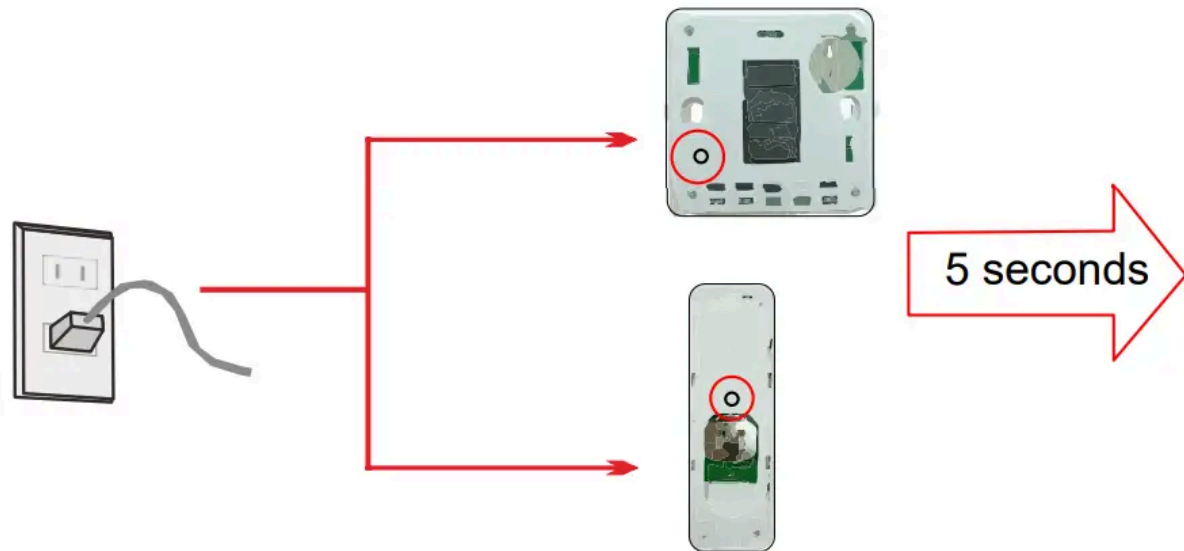
**3-3**

When the motor keeps beeping "dididi".

**3-4**

Press the "down button" of the remote control once and hear the beep of the motor, and the code matching is successful.

